

Carter (010)	Jan 1 Owner	Current Owner	CARTER BRANCH RD 217				
Tax Year 2025   Reappraisal 2021	PIERCE JOYCE G		Ctrl Map:	Group:	Parcel:	PI:	SI:
	EDGAR PIERCE		006		006.01		000
	217 CARTER BRANCH ROAD						
	ELIZABETHTON TN 37643						

Value Information

Land Market Value:	\$13,500
Improvement Value:	\$88,000
Total Market Appraisal:	\$101,500
Assessment Percentage:	25%
Assessment:	\$25,375

Additional Information

General Information

Class: 00 - Residential	City:
City #:	Special Service District 2: 000
Special Service District 1: 000	Neighborhood: S01
District: 12	Number of Mobile Homes:
Number of Buildings: 1	Utilities - Electricity: 01 - PUBLIC
Utilities - Water/Sewer: 03 - PUBLIC / INDIVIDUAL	Zoning:
Utilities - Gas/Gas Type: 00 - NONE	

Outbuildings & Yard Items

Long OutBuilding & Yard Items list on subsequent pages

Sale Information

Long Sale Information list on subsequent pages

Land Information

Deed Acres: 2.84      Calculated Acres:      Total Land Units: 2.84

Land Code	Soil Class	Units
04 - IMP SITE		2.84

Residential Building #: 1

Improvement Type:
01 - SINGLE FAMILY
Exterior Wall:
03 - SIDING BELOW AVG
Heat and AC:
3 - RADIANT HEAT
Quality:
0 - BELOW AVERAGE
Square Feet of Living Area:
1538

Building Sketch

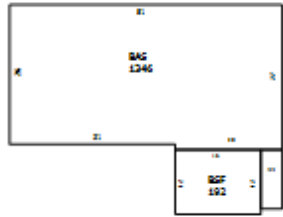

Stories:
1.00
Actual Year Built:
2017
Plumbing Fixtures:
6
Condition:
FR - FAIR

Building Areas

Areas	Square Feet
BAS - BASE	1,346
BSF - BASE SEMI FINISHED	192
OPU - OPEN PORCH UNFINISHED	44

Outbuildings & Yard Items

Building #	Type	Description	Area/Units
1	SHD - SHED	10X20	200
1	WDK - WOOD DECK		400
1	WDK - WOOD DECK		297
1	WDK - WOOD DECK		104

Sale Information

Sale Date	Price	Book	Page	Vacant/Improved	Type Instrument	Qualification
2/26/2002	\$0	472	176		-	-
3/1/1989	\$11,500	434	427	I - IMPROVED	WD - WARRANTY DEED	B - FAMILY SALE
7/5/1981	\$0	327	623		-	-