

Carter (010)	Jan 1 Owner	Current Owner	HWY 91 3034			
Tax Year 2025 Reappraisal 2021	LOWE WILLIAM SHANE		Ctrl Map:	Group:	Parcel:	PI:
	3034 HWY 91		006		084.00	SI:
	ELIZABETHTON TN 37643					000

Value Information

Land Market Value:	\$32,500
Improvement Value:	\$70,100
Total Market Appraisal:	\$102,600
Assessment Percentage:	25%
Assessment:	\$25,650

Subdivision Data

Subdivision:			
Plat Book:	Plat Page:	Block:	Lot:
			2

Additional Information

General Information

Class: 00 - Residential	City:
City #:	Special Service District 2: 000
Special Service District 1: 000	Neighborhood: S01
District: 12	Number of Mobile Homes: 1
Number of Buildings: 1	Utilities - Electricity: 01 - PUBLIC
Utilities - Water/Sewer: 07 - PRIVATE / INDIVIDUAL	Zoning:
Utilities - Gas/Gas Type: 00 - NONE	

Outbuildings & Yard Items

Long OutBuilding & Yard Items list on subsequent pages

Sale Information

Long Sale Information list on subsequent pages

Land Information

Deed Acres: 3.55	Calculated Acres: 0	Total Land Units: 3.55
------------------	---------------------	------------------------

Land Code	Soil Class	Units
04 - IMP SITE		3.55

Residential Building #: 1

Improvement Type:
01 - SINGLE FAMILY
Exterior Wall:
04 - SIDING AVERAGE
Heat and AC:
3 - RADIANT HEAT
Quality:
1 - AVERAGE
Square Feet of Living Area:
1774

Building Sketch

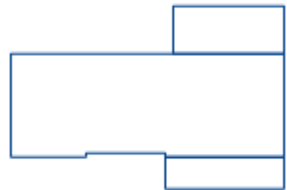

Stories:
1.00
Actual Year Built:
1958
Plumbing Fixtures:
6
Condition:
AV - AVERAGE

Building Areas

Areas	Square Feet
BAS - BASE	1,774
OPU - OPEN PORCH UNFINISHED	240
GRU - GARAGE UNFINISHED	336

Outbuildings & Yard Items

Building #	Type	Description	Area/Units
1	PTO - PATIO	4X4	16
1	GUD - DETACHED GARAGE UNFINISHED	24X30	720
1	SHD - SHED	10X12	120
1	SHD - SHED	9X18	162
1	TBN - TOBACCO BARN	28X36	1,008
1	SHD - SHED	10X24	240

Sale Information

Sale Date	Price	Book	Page	Vacant/Improved	Type Instrument	Qualification
1/16/2014	\$20,000	196	52	I - IMPROVED	WD - WARRANTY DEED	B - FAMILY SALE
12/15/1994	\$0	416	388		-	-
7/30/1960	\$0	201	187		-	-
3/12/1959	\$0	194	309		-	-
9/15/1958	\$0	196	451		-	-