

Carter (010)	Jan 1 Owner	Current Owner	GEORGE BOWERS RD 216				
Tax Year 2025 Reappraisal 2021	PARKER DOUGLAS C.		Ctrl Map:	Group:	Parcel:	PI:	SI:
	CYNTHIA PARKER		028M	A	018.01		000
	216 GEORGE BOWERS RD						
	ELIZABETHTON TN 37643						

Value Information			Residential Building #: 1		
Land Market Value:	\$28,000		Improvement Type:	01 - SINGLE FAMILY	Stories:
Improvement Value:	\$126,100		Exterior Wall:	04 - SIDING AVERAGE	1.00
Total Market Appraisal:	\$154,100		Heat and AC:	7 - HEAT AND COOLING SPLIT	Actual Year Built:
Assessment Percentage:	25%		Quality:	1 - AVERAGE	2000
Assessment:	\$38,525		Square Feet of Living Area:	1488	Plumbing Fixtures:

Additional Information

94 X 206

General Information

Class: 00 - Residential	City:
City #:	Special Service District 2: 000
Special Service District 1: 000	Neighborhood: I01
District: 09	Number of Mobile Homes: 0
Number of Buildings: 1	Utilities - Electricity: 01 - PUBLIC
Utilities - Water/Sewer: 03 - PUBLIC / INDIVIDUAL	Zoning:
Utilities - Gas/Gas Type: 00 - NONE	

Outbuildings & Yard Items

Building #	Type	Description	Area/Units
1	WDK - WOOD DECK	8X14	112
1	CPY - CANOPY	8X14	112

Sale Information

Long Sale Information list on subsequent pages

Land Information

Deed Acres: 0.4 Calculated Acres: 0 Total Land Units: 0.4

Land Code	Soil Class	Units
04 - IMP SITE		0.40

Building Sketch

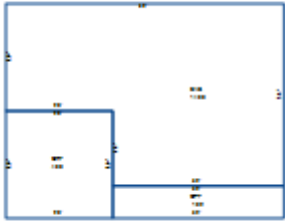

Building Areas

Areas	Square Feet
BAS - BASE	1,488
OPF - OPEN PORCH FINISHED	192
GRF - GARAGE FINISHED	400

Sale Information						
Sale Date	Price	Book	Page	Vacant/Improved	Type Instrument	Qualification
12/13/2021	\$189,800	467	45	I - IMPROVED	WD - WARRANTY DEED	A - ACCEPTED
12/7/2021	\$0	466	328		HR - AFFIDAVIT OF HEIRSHIP	-
10/28/2021	\$0	461	39		HR - AFFIDAVIT OF HEIRSHIP	-
12/18/2020	\$0	419	817		QC - QUITCLAIM DEED	-
3/8/2001	\$0	460	459		-	-
2/28/2001	\$107,000	460	456	I - IMPROVED	WD - WARRANTY DEED	A - ACCEPTED