

Greene (030)	Jan 1 Owner	Current Owner	OLD BAILEYTON RD 1795			
Tax Year 2026 Reappraisal 2023	JOHNSON JIMMIE & JOYCE ANN 105-B COX CIR GREENEVILLE TN 37743		Ctrl Map: 044	Group:	Parcel: 065.00	PI: SI: 000

Value Information

Land Market Value:	\$13,300
Improvement Value:	\$11,300
Total Market Appraisal:	\$24,600
Assessment Percentage:	25%
Assessment:	\$6,150

Additional Information

General Information

Class: 00 - Residential	City:
City #:	Special Service District 2: 000
Special Service District 1: 000	Neighborhood: R02
District: 21	Number of Mobile Homes: 0
Number of Buildings: 1	Utilities - Electricity: 01 - PUBLIC
Utilities - Water/Sewer: 03 - PUBLIC / INDIVIDUAL	Zoning: A-1
Utilities - Gas/Gas Type: 00 - NONE	

Outbuildings & Yard Items

Building #	Type	Description	Area/Units
------------	------	-------------	------------

Sale Information

Sale Date	Price	Book	Page	Vacant/Improved	Type Instrument	Qualification
1/1/1900	\$0	277	13		-	-

Land Information

Deed Acres: 0	Calculated Acres: 0	Total Land Units: 0.55
Land Code	Soil Class	Units
04 - IMP SITE		0.55

Residential Building #: 1

Improvement Type:	Stories:
01 - SINGLE FAMILY	1.00
Exterior Wall:	Actual Year Built:
11 - COMMON BRICK	1957
Heat and AC:	Plumbing Fixtures:
0 - NONE	0
Quality:	Condition:
0- - BELOW AVERAGE -	AV - AVERAGE
Square Feet of Living Area:	Floor System:
1179	03 - WOOD W/O SUB FLOOR
Foundation:	Roof Cover/Deck:
02 - CONTINUOUS FOOTING	03 - COMPOSITION SHINGLE
Roof Framing:	Floor Finish:
02 - GABLE/HIP	05 - VINYL ASBESTOS TILE
Cabinet/Millwork:	Paint/Decor:
00 - NONE	00 - NONE
Interior Finish:	Electrical:
00 - NONE	00 - NONE
Bath Tiles:	Structural Frame:
00 - NONE	00 - NONE
Shape:	
01 - RECTANGLE	

Building Sketch

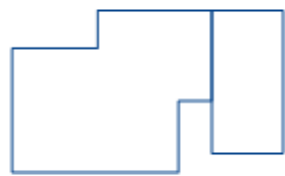

Building Areas

Areas	Square Feet
BAS - BASE	1,179
GRU - GARAGE UNFINISHED	450