

Maury (060)
Tax Year 2025 | Reappraisal 2022

Jan 1 Owner
 HUBBELL LARRY
 410 W 7TH
 COLUMBIA TN 38401

Current Owner

S JAMES M CAMPBELL BLVD 304

Ctrl Map: 113D Group: K Parcel: 009.00 Pl: SI: 000

Value Information

Land Market Value: \$195,000
Improvement Value: \$184,300
Total Market Appraisal: \$379,300
Assessment Percentage: 40%
Assessment: \$151,720

Additional Information

LUCKY TATTOO COMPANY

General Information

Class: 08 - Commercial
City #: 156
Special Service District 1: 000
District: 09
Number of Buildings: 3
Utilities - Water/Sewer: 01 - PUBLIC / PUBLIC
Utilities - Gas/Gas Type: 01 - PUBLIC - NATURAL GAS

City: COLUMBIA
Special Service District 2: 000
Neighborhood: Z31
Number of Mobile Homes: 0
Utilities - Electricity: 01 - PUBLIC
Zoning:

Outbuildings & Yard Items

Building #	Type	Description	Area/Units
1	ASP - ASPHALT PAVING		3,000
1	CLF - CHAIN LINK FENCE		60

Sale Information

Long Sale Information list on subsequent pages

Land Information

Deed Acres: 0 **Calculated Acres:** 0 **Total Land Units:** 1

Land Code	Soil Class	Units
10 - COM		1.00

Commercial Building #: 1

Improvement Type:
 20 - STORE
Quality:
 1+ - AVERAGE +
Foundation:
 02 - CONTINUOUS FOOTING
Roof Framing:
 02 - GABLE/HIP
Cabinet/Millwork:
 03 - AVERAGE
Interior Finish:
 07 - DRYWALL
Bath Tiles:
 00 - NONE
Shape:
 01 - RECTANGLE
Heat and AC:
 07 - HVAC SPLIT

Building Sketch

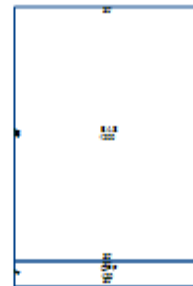

Actual Year Built:

1978

Business Living Area:

1200

Floor System:

01 - SLAB ON GRADE

Roof Cover/Deck:

03 - COMPOSITION SHINGLE

Floor Finish:

11 - CARPET COMBINATION

Paint/Decor:

03 - AVERAGE

Electrical:

03 - AVERAGE

Structural Frame:

00 - NONE

Plumbing Fixtures:

4

Interior/Exterior Areas

Type	Square Feet	Exterior Wall
20 - STORE	1,200	07 - CONCRETE BLOCK

Commercial Features

Type	Units
OPF - OPEN PORCH FINISHED	120 X 1

Residential Building #: 3

Improvement Type:

01 - SINGLE FAMILY

Exterior Wall:

07 - CONCRETE BLOCK

Heat and AC:

7 - HEAT AND COOLING SPLIT

Quality:

1 - AVERAGE

Square Feet of Living Area:

1080

Foundation:

02 - CONTINUOUS FOOTING

Roof Framing:

02 - GABLE/HIP

Cabinet/Millwork:

03 - AVERAGE

Interior Finish:

10 - PANEL-PLAST-DRYWALL

Bath Tiles:

00 - NONE

Shape:

00 - SQUARE

Building Sketch

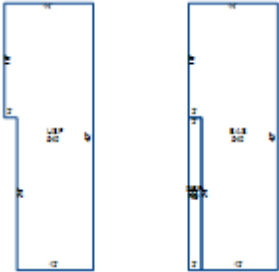

Stories:

2.00

Actual Year Built:

1978

Plumbing Fixtures:

5

Condition:

AV - AVERAGE

Floor System:

01 - SLAB ON GRADE

Roof Cover/Deck:

03 - COMPOSITION SHINGLE

Floor Finish:

11 - CARPET COMBINATION

Paint/Decor:

03 - AVERAGE

Electrical:

03 - AVERAGE

Structural Frame:

00 - NONE

Building Areas

Areas	Square Feet
BAS - BASE	540
USF - UPPER STORY FINISHED	540
OPF - OPEN PORCH FINISHED	48

Commercial Building #: 2

Improvement Type:

20 - STORE

Quality:

1+ - AVERAGE +

Foundation:

02 - CONTINUOUS FOOTING

Roof Framing:

02 - GABLE/HIP

Cabinet/Millwork:

03 - AVERAGE

Interior Finish:

07 - DRYWALL

Bath Tiles:

00 - NONE

Shape:

01 - RECTANGLE

Heat and AC:

07 - HVAC SPLIT

Building Sketch



Actual Year Built:

1978

Business Living Area:

1456

Floor System:

01 - SLAB ON GRADE

Roof Cover/Deck:

03 - COMPOSITION SHINGLE

Floor Finish:

11 - CARPET COMBINATION

Paint/Decor:

03 - AVERAGE

Electrical:

03 - AVERAGE

Structural Frame:

00 - NONE

Plumbing Fixtures:

2

Interior/Exterior Areas

Type	Square Feet	Exterior Wall
20 - STORE	1,456	04 - SIDING AVERAGE

Commercial Features

Type	Units
OPF - OPEN PORCH FINISHED	168 X 1

Sale Information

Sale Date	Price	Book	Page	Vacant/Improved	Type Instrument	Qualification
10/19/2021	\$550,000	R2781	304	I - IMPROVED	WD - WARRANTY DEED	M - PHYSICAL DIFFERENCE
1/31/2020	\$340,000	R2610	1411	I - IMPROVED	WD - WARRANTY DEED	L - LIMITED
10/3/2014	\$240,000	R2297	1291	I - IMPROVED	WD - WARRANTY DEED	L - LIMITED
9/1/2003	\$210,000	R1746	667	I - IMPROVED	WD - WARRANTY DEED	L - LIMITED
1/11/2001	\$210,000	R1517	530	I - IMPROVED	WD - WARRANTY DEED	P - MULTIPLE PARCELS
7/31/1996	\$633,289	1299	31	I - IMPROVED	WD - WARRANTY DEED	P - MULTIPLE PARCELS
5/19/1992	\$10	1149	286	I - IMPROVED	QC - QUITCLAIM DEED	D -
11/2/1990	\$0	849	266		-	-
9/25/1989	\$0	821	418		-	-
8/14/1973	\$0	553	628		-	-