

**Sevier (078)**  
**Tax Year 2026 | Reappraisal 2026**

Jan 1 Owner  
 CORBITT R STEVE  
 412 OVERALL DR  
 BRENTWOOD TN 37027

Current Owner

**ROARING FORK RD 260**  
 Ctrl Map: 1271    Group: B    Parcel: 034.00    Pl: C    SI: 008

**Value Information**

**Land Market Value:** \$110,000  
**Improvement Value:** \$117,200  
**Total Market Appraisal:** \$227,200  
**Assessment Percentage:** 25%  
**Assessment:** \$56,800

**Subdivision Data**

**Subdivision:** ALPINE VILLAGE  
**Plat Book:** 20    **Plat Page:** 55    **Block:** A    **Lot:** 108

**Additional Information**

Y39TH INT  
 UNIT 108 WING A

**General Information**

**Class:** 00 - Residential  
**City #:** 287  
**Special Service District 1:** 000  
**District:** 11  
**Number of Buildings:** 1  
**Utilities - Water/Sewer:** 01 - PUBLIC / PUBLIC  
**Utilities - Gas/Gas Type:** 00 - NONE

**City:** GATLINBURG  
**Special Service District 2:** 000  
**Neighborhood:** K12  
**Number of Mobile Homes:** 0  
**Utilities - Electricity:** 01 - PUBLIC  
**Zoning:** R-1

**Outbuildings & Yard Items**

Building #	Type	Description	Area/Units
1	CMN - COMMON AREA		1
1	FPL - FIREPLACE		1

**Sale Information**

Long Sale Information list on subsequent pages

**Land Information**

**Deed Acres:** 0    **Calculated Acres:** 0    **Total Land Units:** 1

Land Code	Soil Class	Units
01 - RES		1.00

**Commercial Building #: 1**

**Improvement Type:** 12 - CONDO COM  
**Quality:** 1+ - AVERAGE +  
**Foundation:** 02 - CONTINUOUS FOOTING  
**Roof Framing:** 03 - MANSARD  
**Cabinet/Millwork:** 03 - AVERAGE  
**Interior Finish:** 10 - PANEL-PLAST-DRYWALL  
**Bath Tiles:** 01 - FLOOR ONLY  
**Shape:** 01 - RECTANGLE  
**Heat and AC:** 08 - HVAC PKG  
**Building Sketch**

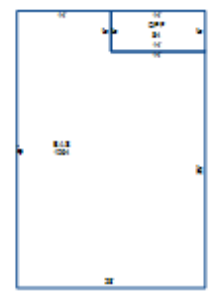

**Actual Year Built:** 1974  
**Business Living Area:** 1064  
**Floor System:** 01 - SLAB ON GRADE  
**Roof Cover/Deck:** 06 - ASBESTOS/WD SHINGLE  
**Floor Finish:** 11 - CARPET COMBINATION  
**Paint/Decor:** 03 - AVERAGE  
**Electrical:** 03 - AVERAGE  
**Structural Frame:** 00 - NONE  
**Plumbing Fixtures:** 6  
**Interior/Exterior Areas**

Type	Square Feet	Exterior Wall
12 - CONDO COM	1,064	07 - CONCRETE BLOCK

**Commercial Features**

Type	Units
OPF - OPEN PORCH FINISHED	84 X 1

**Sale Information**

<b>Sale Date</b>	<b>Price</b>	<b>Book</b>	<b>Page</b>	<b>Vacant/Improved</b>	<b>Type Instrument</b>	<b>Qualification</b>
4/22/2021	\$50,000	5770	720	I - IMPROVED	WD - WARRANTY DEED	E - PARTIAL INTEREST
8/18/2008	\$0	3169	363		-	-
1/1/1900	\$0	255	547		-	-