

Sullivan (082)
Tax Year 2026 | Reappraisal 2025

Jan 1 Owner
 RECTOR DELORES ANN & DANNY
 1778 FOREST VIEW DR
 KINGSPORT TN 37660

Current Owner

FOREST VIEW DR 1778

Ctrl Map: 013N Group: F Parcel: 016.10 Pl: SI: 000

Value Information

Land Market Value: \$10,000
 Improvement Value: \$329,300
 Total Market Appraisal: \$339,300
 Assessment Percentage: 25%
 Assessment: \$84,825

Additional Information

General Information

Class: 00 - Residential
 City #:
 Special Service District 1: 000
 District: 11
 Number of Buildings: 1
 Utilities - Water/Sewer: 03 - PUBLIC / INDIVIDUAL
 Utilities - Gas/Gas Type: 00 - NONE

City:
 Special Service District 2: 000
 Neighborhood: K03
 Number of Mobile Homes: 0
 Utilities - Electricity: 01 - PUBLIC
 Zoning: R-1

Outbuildings & Yard Items

Building #	Type	Description	Area/Units
1	WDK - WOOD DECK	10X16	160
1	SHD - SHED	8X16	128

Sale Information

Long Sale Information list on subsequent pages

Land Information

Deed Acres: 0 Calculated Acres: .33 Total Land Units: 0.33

Land Code	Soil Class	Units
01 - RES		0.33

Residential Building #: 1

Improvement Type:
 01 - SINGLE FAMILY
Exterior Wall:
 04 - SIDING AVERAGE
Heat and AC:
 7 - HEAT AND COOLING SPLIT
Quality:
 1 - AVERAGE
Square Feet of Living Area:
 2464
Foundation:
 02 - CONTINUOUS FOOTING
Roof Framing:
 02 - GABLE/HIP
Cabinet/Millwork:
 03 - AVERAGE
Interior Finish:
 07 - DRYWALL
Bath Tiles:
 00 - NONE
Shape:
 01 - RECTANGLE

Stories:
 1.00
Actual Year Built:
 1986
Plumbing Fixtures:
 6
Condition:
 AV - AVERAGE
Floor System:
 04 - WOOD W/ SUB FLOOR
Roof Cover/Deck:
 13 - PREFIN METAL CRIMPED
Floor Finish:
 11 - CARPET COMBINATION
Paint/Decor:
 03 - AVERAGE
Electrical:
 03 - AVERAGE
Structural Frame:
 00 - NONE

Building Sketch

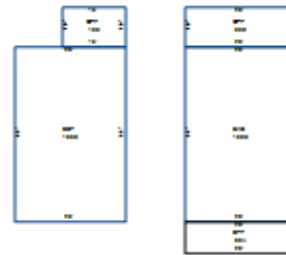

Building Areas

Areas	Square Feet
BAS - BASE	1,232
BSF - BASE SEMI FINISHED	1,232
OPF - OPEN PORCH FINISHED	280
OPF - OPEN PORCH FINISHED	160
SPF - SCREEN PORCH FINISHED	224

Sale Information

Sale Date	Price	Book	Page	Vacant/Improved	Type Instrument	Qualification
6/17/2009	\$0	2788C	274		-	-
5/2/1991	\$0	776C	695		-	-
4/29/1991	\$0	773C	119		-	-
10/22/1981	\$0	298C	633		-	-