

Sullivan (082)
Tax Year 2026 | Reappraisal 2025

Jan 1 Owner
 WEST JAMIE
 420 LUCY RD
 KINGSPORT TN 37660

Current Owner

LUCY RD 420

Ctrl Map: 014J Group: A Parcel: 013.00 Pl: Sl: 000

Value Information

Land Market Value: \$12,800
 Improvement Value: \$106,600
 Total Market Appraisal: \$119,400
 Assessment Percentage: 25%
 Assessment: \$29,850

Subdivision Data

Subdivision: MINTON HTS
 Plat Book: 3 Plat Page: 14 Block: Lot: 115&

Additional Information

General Information

Class: 00 - Residential City #: City:
 Special Service District 1: 000 Special Service District 2: 000
 District: 10 Neighborhood: A01
 Number of Buildings: 1 Number of Mobile Homes: 0
 Utilities - Water/Sewer: 03 - PUBLIC / INDIVIDUAL Utilities - Electricity: 01 - PUBLIC
 Utilities - Gas/Gas Type: 00 - NONE Zoning: R-1

Outbuildings & Yard Items

Building #	Type	Description	Area/Units
1	UTB - UTILITY BUILDING	12X24	288

Sale Information

Long Sale Information list on subsequent pages

Land Information

Deed Acres: 0 Calculated Acres: .3 Total Land Units: 0.3

Land Code	Soil Class	Units
01 - RES		0.30

Residential Building #: 1

Improvement Type: 51 - SINGLE FAMILY
 Exterior Wall: 04 - SIDING AVERAGE
 Heat and AC: 7 - HEAT AND COOLING SPLIT
 Quality: 1 - AVERAGE
 Square Feet of Living Area: 792
 Foundation: 02 - CONTINUOUS FOOTING
 Roof Framing: 02 - GABLE/HIP
 Cabinet/Millwork: 02 - BELOW AVG
 Interior Finish: 11 - PANELING BELOW AVG
 Bath Tiles: 00 - NONE
 Shape: 01 - RECTANGLE

Building Sketch

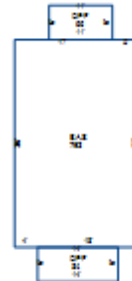

Stories: 1.00
 Actual Year Built: 1943
 Plumbing Fixtures: 3
 Condition: AV - AVERAGE
 Floor System: 04 - WOOD W/ SUB FLOOR
 Roof Cover/Deck: 03 - COMPOSITION SHINGLE
 Floor Finish: 09 - HARDWOOD/PARQUE
 Paint/Decor: 03 - AVERAGE
 Electrical: 03 - AVERAGE
 Structural Frame: 00 - NONE

Building Areas

Areas	Square Feet
BAS - BASE	792
OPF - OPEN PORCH FINISHED	84
OPF - OPEN PORCH FINISHED	66

Sale Information

Sale Date	Price	Book	Page	Vacant/Improved	Type Instrument	Qualification
5/20/2025	\$0	3655	2763		QC - QUITCLAIM DEED	-
2/3/2012	\$0	3023	1667		-	-
4/14/2009	\$0	2761C	766		-	-
3/17/2009	\$20,000	2761C	763	I - IMPROVED	WD - WARRANTY DEED	A - ACCEPTED
12/21/2006	\$15,000	2485C	309	I - IMPROVED	WD - WARRANTY DEED	J - ESTATE SALE