

Sullivan (082)
Tax Year 2026 | Reappraisal 2025

Jan 1 Owner
 KINDLE JULIA ANN
 3444 BLOOMINGDALE RD
 KINGSPORT TN 37660

Current Owner

BLOOMINGDALE RD 3444
 Ctrl Map: 014M Group: D Parcel: 024.00 Pl: SI: 000

Value Information

Land Market Value: \$9,100
 Improvement Value: \$145,600
 Total Market Appraisal: \$154,700
 Assessment Percentage: 25%
 Assessment: \$38,675

Subdivision Data

Subdivision: MCCREARY MANOR
 Plat Book: 3 Plat Page: 4B-C Block: A Lot: 33

Additional Information

General Information

Class: 00 - Residential City #: City:
 Special Service District 1: 000 Special Service District 2: 000
 District: 10 Neighborhood: A01
 Number of Buildings: 1 Number of Mobile Homes: 0
 Utilities - Water/Sewer: 03 - PUBLIC / INDIVIDUAL Utilities - Electricity: 01 - PUBLIC
 Utilities - Gas/Gas Type: 00 - NONE Zoning: R-3A

Outbuildings & Yard Items

Building #	Type	Description	Area/Units
1	GUD - DETACHED GARAGE UNFINISHED	20X24	480

Sale Information

Long Sale Information list on subsequent pages

Land Information

Deed Acres: 0 Calculated Acres: .18 Total Land Units: 0.18

Land Code	Soil Class	Units
01 - RES		0.18

Residential Building #: 1

Improvement Type: 51 - SINGLE FAMILY
 Exterior Wall: 04 - SIDING AVERAGE
 Heat and AC: 3 - RADIANT HEAT
 Quality: 1 - AVERAGE
 Square Feet of Living Area: 1032
 Foundation: 02 - CONTINUOUS FOOTING
 Roof Framing: 02 - GABLE/HIP
 Cabinet/Millwork: 03 - AVERAGE
 Interior Finish: 11 - PANELING BELOW AVG
 Bath Tiles: 00 - NONE
 Shape: 01 - RECTANGLE

Building Sketch

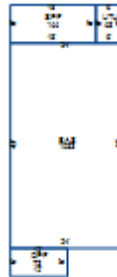

Stories: 1.00
 Actual Year Built: 1945
 Plumbing Fixtures: 6
 Condition: AV - AVERAGE
 Floor System: 04 - WOOD W/ SUB FLOOR
 Roof Cover/Deck: 13 - PREFIN METAL CRIMPED
 Floor Finish: 11 - CARPET COMBINATION
 Paint/Decor: 03 - AVERAGE
 Electrical: 02 - BELOW AVG
 Structural Frame: 00 - NONE

Building Areas

Areas	Square Feet
BAS - BASE	1,032
SPF - SCREEN PORCH FINISHED	144
OPF - OPEN PORCH FINISHED	72
UTU - UTILITY UNFINISHED	48

Sale Information

Sale Date	Price	Book	Page	Vacant/Improved	Type Instrument	Qualification
7/26/1988	\$0	973C	286		-	-
6/7/1985	\$0	445C	746		-	-
4/8/1980	\$16,000	242C	792	I - IMPROVED	WD - WARRANTY DEED	A - ACCEPTED