

**Sullivan (082)**  
**Tax Year 2026 | Reappraisal 2025**

Jan 1 Owner  
 CARTER CHERYL L  
 1600 BROAD ST  
 BRISTOL TN 37620

Current Owner

**BROAD ST 1600**  
 Ctrl Map: 020C    Group: H    Parcel: 006.00    Pl:    SI: 000

**Value Information**

Land Market Value: \$7,800  
 Improvement Value: \$111,900  
 Total Market Appraisal: \$119,700  
 Assessment Percentage: 25%  
 Assessment: \$29,925

**Subdivision Data**

Subdivision: CLIFTON LAND  
 Plat Book: 1    Plat Page: 49    Block: 3    Lot: 19

**Additional Information**

**General Information**

Class: 00 - Residential    City: BRISTOL  
 City #: 090    Special Service District 2: 000  
 Special Service District 1: 000    Neighborhood: B01  
 District: 17    Number of Mobile Homes: 0  
 Number of Buildings: 1    Utilities - Electricity: 01 - PUBLIC  
 Utilities - Water/Sewer: 01 - PUBLIC / PUBLIC    Zoning:  
 Utilities - Gas/Gas Type: 00 - NONE

**Outbuildings & Yard Items**

Building #	Type	Description	Area/Units
------------	------	-------------	------------

**Sale Information**

Long Sale Information list on subsequent pages

**Land Information**

Deed Acres: 0    Calculated Acres: .1    Total Land Units: 0.1

Land Code	Soil Class	Units
01 - RES		0.10

**Residential Building #: 1**

Improvement Type: 51 - SINGLE FAMILY  
 Exterior Wall: 04 - SIDING AVERAGE  
 Heat and AC: 7 - HEAT AND COOLING SPLIT  
 Quality: 1 - AVERAGE  
 Square Feet of Living Area: 1080  
 Foundation: 02 - CONTINUOUS FOOTING  
 Roof Framing: 02 - GABLE/HIP  
 Cabinet/Millwork: 03 - AVERAGE  
 Interior Finish: 07 - DRYWALL  
 Bath Tiles: 00 - NONE  
 Shape: 01 - RECTANGLE

Stories: 1.00  
 Actual Year Built: 1943  
 Plumbing Fixtures: 3  
 Condition: AV - AVERAGE  
 Floor System: 04 - WOOD W/ SUB FLOOR  
 Roof Cover/Deck: 03 - COMPOSITION SHINGLE  
 Floor Finish: 09 - HARDWOOD/PARQUE  
 Paint/Decor: 03 - AVERAGE  
 Electrical: 03 - AVERAGE  
 Structural Frame: 00 - NONE

**Building Sketch**

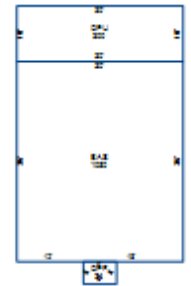

**Building Areas**

Areas	Square Feet
BAS - BASE	1,080
OPF - OPEN PORCH FINISHED	24
OPU - OPEN PORCH UNFINISHED	300

**Sale Information**

<b>Sale Date</b>	<b>Price</b>	<b>Book</b>	<b>Page</b>	<b>Vacant/Improved</b>	<b>Type Instrument</b>	<b>Qualification</b>
9/15/2004	\$70,000	608	376	I - IMPROVED	WD - WARRANTY DEED	A - ACCEPTED
3/18/1994	\$24,500	347	239	I - IMPROVED	WD - WARRANTY DEED	A - ACCEPTED
8/22/1985	\$0	239	708		-	-
6/21/1973	\$0	145	979		-	-