

**Sullivan (082)**  
**Tax Year 2026 | Reappraisal 2025**

Jan 1 Owner  
 OLINGER AMY MARIE  
 1714 WINDSOR AVE  
 BRISTOL TN 37620

Current Owner

**WINDSOR AVE 1714**  
 Ctrl Map: 020C    Group: J    Parcel: 002.00    Pl:    SI: 000

**Value Information**

**Land Market Value:** \$17,400  
**Improvement Value:** \$294,700  
**Total Market Appraisal:** \$312,100  
**Assessment Percentage:** 25%  
**Assessment:** \$78,025

**Subdivision Data**

**Subdivision:** WINDSOR TERRACE  
**Plat Book:** DB49    **Plat Page:** 33    **Block:**    **Lot:** 27

**Additional Information**

**General Information**

**Class:** 00 - Residential    **City:** BRISTOL  
**City #:** 090    **Special Service District 2:** 000  
**Special Service District 1:** 000    **Neighborhood:** B01  
**District:** 17    **Number of Mobile Homes:** 0  
**Number of Buildings:** 1    **Utilities - Electricity:** 01 - PUBLIC  
**Utilities - Water/Sewer:** 01 - PUBLIC / PUBLIC    **Zoning:**  
**Utilities - Gas/Gas Type:** 01 - PUBLIC - NATURAL

**Outbuildings & Yard Items**

Long OutBuilding & Yard Items list on subsequent pages

**Sale Information**

Long Sale Information list on subsequent pages

**Land Information**

**Deed Acres:** 0    **Calculated Acres:** .24    **Total Land Units:** 0.24

Land Code	Soil Class	Units
01 - RES		0.24

**Residential Building #: 1**

**Improvement Type:** 03 - SPECIAL\_RES  
**Exterior Wall:** 09 - CONC BLOCK.STUCCO  
**Heat and AC:** 7 - HEAT AND COOLING SPLIT  
**Quality:** 1 - AVERAGE  
**Square Feet of Living Area:** 2000  
**Foundation:** 02 - CONTINUOUS FOOTING  
**Roof Framing:** 02 - GABLE/HIP  
**Cabinet/Millwork:** 03 - AVERAGE  
**Interior Finish:** 08 - PLASTERED DIRECT  
**Bath Tiles:** 00 - NONE  
**Shape:** 03 - U-SHAPED

**Building Sketch**

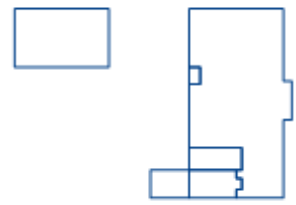

**Stories:** 1.00  
**Actual Year Built:** 1933  
**Plumbing Fixtures:** 3  
**Condition:** AV - AVERAGE  
**Floor System:** 04 - WOOD W/ SUB FLOOR  
**Roof Cover/Deck:** 13 - PREFIN METAL CRIMPED  
**Floor Finish:** 11 - CARPET COMBINATION  
**Paint/Decor:** 03 - AVERAGE  
**Electrical:** 03 - AVERAGE  
**Structural Frame:** 00 - NONE

**Building Areas**

Areas	Square Feet
BAS - BASE	2,000
EPF - ENCLOSED PORCH FINISHED	24
OPF - OPEN PORCH FINISHED	178
CPF - CARPORT FINISHED	140
BMU - BASEMENT UNFINISHED	714
OPU - OPEN PORCH UNFINISHED	152

**Outbuildings & Yard Items**

Building #	Type	Description	Area/Units
1	UTB - UTILITY BUILDING	20X18	360
1	PTO - PATIO	16X13	208
1	CUD - DETACHED CARPORT UNFINISHED	18X22	396

**Sale Information**

Sale Date	Price	Book	Page	Vacant/Improved	Type Instrument	Qualification
3/13/2007	\$150,000	688	176	I - IMPROVED	WD - WARRANTY DEED	A - ACCEPTED
7/12/2005	\$90,000	633	576	I - IMPROVED	WD - WARRANTY DEED	A - ACCEPTED
7/7/2000	\$83,000	464	729	I - IMPROVED	WD - WARRANTY DEED	A - ACCEPTED
12/28/1988	\$0	281	623		-	-