

**Sullivan (082)**  
**Tax Year 2026 | Reappraisal 2025**

Jan 1 Owner  
 EDWARDS PEGGY MARIE  
 212 DELANEY ST  
 BRISTOL TN 37620

Current Owner

**DELANEY ST 214**  
 Ctrl Map: 021B    Group: G    Parcel: 017.00    Pl:    SI: 000

**Value Information**

Land Market Value: \$19,200  
 Improvement Value: \$142,900  
 Total Market Appraisal: \$162,100  
 Assessment Percentage: 25%  
 Assessment: \$40,525

**Subdivision Data**

Subdivision: ROSEWOOD ADD  
 Plat Book: 1    Plat Page: 88    Block: 3    Lot: 16-

**Additional Information**

CARD 2 HSE # 212

**General Information**

Class: 00 - Residential  
 City #: 090  
 Special Service District 1: 000  
 District: 17  
 Number of Buildings: 2  
 Utilities - Water/Sewer: 01 - PUBLIC / PUBLIC  
 Utilities - Gas/Gas Type: 00 - NONE

City: BRISTOL  
 Special Service District 2: 000  
 Neighborhood: B01  
 Number of Mobile Homes: 0  
 Utilities - Electricity: 01 - PUBLIC  
 Zoning:

**Outbuildings & Yard Items**

Long OutBuilding & Yard Items list on subsequent pages

**Sale Information**

Long Sale Information list on subsequent pages

**Land Information**

Deed Acres: 0    Calculated Acres: .3    Total Land Units: 0.3

Land Code	Soil Class	Units
01 - RES		0.30

**Residential Building #: 1**

Improvement Type: 51 - SINGLE FAMILY  
 Exterior Wall: 04 - SIDING AVERAGE  
 Heat and AC: 0 - NONE  
 Quality: 0+ - BELOW AVERAGE +  
 Square Feet of Living Area: 1050  
 Foundation: 02 - CONTINUOUS FOOTING  
 Roof Framing: 02 - GABLE/HIP  
 Cabinet/Millwork: 02 - BELOW AVG  
 Interior Finish: 07 - DRYWALL  
 Bath Tiles: 00 - NONE  
 Shape: 01 - RECTANGLE

Stories: 1.00  
 Actual Year Built: 1940  
 Plumbing Fixtures: 3  
 Condition: AV - AVERAGE  
 Floor System: 04 - WOOD W/ SUB FLOOR  
 Roof Cover/Deck: 03 - COMPOSITION SHINGLE  
 Floor Finish: 09 - HARDWOOD/PARQUE  
 Paint/Decor: 02 - BELOW AVERAGE  
 Electrical: 03 - AVERAGE  
 Structural Frame: 00 - NONE

**Building Sketch**

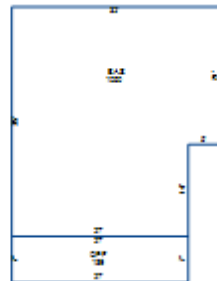

**Building Areas**

Areas	Square Feet
BAS - BASE	1,050
OPF - OPEN PORCH FINISHED	189

**Residential Building #: 2**

**Improvement Type:**

51 - SINGLE FAMILY

**Exterior Wall:**

04 - SIDING AVERAGE

**Heat and AC:**

0 - NONE

**Quality:**

1- - AVERAGE -

**Square Feet of Living Area:**

912

**Foundation:**

02 - CONTINUOUS FOOTING

**Roof Framing:**

02 - GABLE/HIP

**Cabinet/Millwork:**

02 - BELOW AVG

**Interior Finish:**

07 - DRYWALL

**Bath Tiles:**

00 - NONE

**Shape:**

02 - L-SHAPED

**Building Sketch**

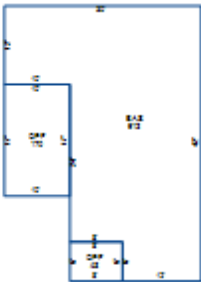

**Stories:**

1.00

**Actual Year Built:**

1940

**Plumbing Fixtures:**

3

**Condition:**

AV - AVERAGE

**Floor System:**

04 - WOOD W/ SUB FLOOR

**Roof Cover/Deck:**

13 - PREFIN METAL CRIMPED

**Floor Finish:**

09 - HARDWOOD/PARQUE

**Paint/Decor:**

02 - BELOW AVERAGE

**Electrical:**

03 - AVERAGE

**Structural Frame:**

00 - NONE

**Building Areas**

Areas	Square Feet
BAS - BASE	912
OPF - OPEN PORCH FINISHED	48
OPF - OPEN PORCH FINISHED	170

**Outbuildings & Yard Items**

Building #	Type	Description	Area/Units
1	GUD - DETACHED GARAGE UNFINISHED	20X32	640
1	CPY - CANOPY	8X14	112
1	PTO - PATIO	8X14	112
2	CUD - DETACHED CARPORT UNFINISHED	18X18	324
2	WDK - WOOD DECK	12X16	192

**Sale Information**

Sale Date	Price	Book	Page	Vacant/Improved	Type Instrument	Qualification
6/3/2016	\$0	3230	474		ED - EXECUTOR/EXECUTRIX DEED	-
7/14/1937	\$0	00066	00144		-	-
9/7/1935	\$0	00063	00595		-	-
1/1/1900	\$0	NA	NA		-	-