

Sullivan (082)
Tax Year 2026 | Reappraisal 2025

Jan 1 Owner
 Current Owner
 CORDLE CAROL
 216 MELODY LN
 BRISTOL TN 37620

MELODY LN 216
 Ctrl Map: 021E Group: E Parcel: 006.00 Pl: SI: 000

Value Information

Land Market Value: \$29,300
 Improvement Value: \$322,700
 Total Market Appraisal: \$352,000
 Assessment Percentage: 25%
 Assessment: \$88,000

Subdivision Data

Subdivision: REDSTONE
 Plat Book: 2 Plat Page: 217 Block: A Lot: 9

Additional Information

General Information

Class: 00 - Residential City: BRISTOL
 City #: 090 Special Service District 2: 000
 Special Service District 1: 000 Neighborhood: B01
 District: 02 Number of Mobile Homes: 0
 Number of Buildings: 1 Utilities - Electricity: 01 - PUBLIC
 Utilities - Water/Sewer: 01 - PUBLIC / PUBLIC Zoning:
 Utilities - Gas/Gas Type: 00 - NONE

Outbuildings & Yard Items

Building #	Type	Description	Area/Units
1	STP - STOOP	4X11	44
1	WDK - WOOD DECK	8X18	144

Sale Information

Long Sale Information list on subsequent pages

Land Information

Deed Acres: 0 Calculated Acres: .45 Total Land Units: 0.45

Land Code	Soil Class	Units
01 - RES		0.45

Residential Building #: 1

Improvement Type: 01 - SINGLE FAMILY
 Exterior Wall: 11 - COMMON BRICK
 Heat and AC: 7 - HEAT AND COOLING SPLIT
 Quality: 1 - AVERAGE
 Square Feet of Living Area: 2338
 Foundation: 02 - CONTINUOUS FOOTING
 Roof Framing: 02 - GABLE/HIP
 Cabinet/Millwork: 03 - AVERAGE
 Interior Finish: 07 - DRYWALL
 Bath Tiles: 00 - NONE
 Shape: 02 - L-SHAPED

Building Sketch

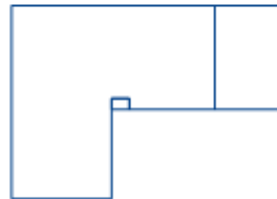

Stories: 1.00
 Actual Year Built: 1965
 Plumbing Fixtures: 9
 Condition: AV - AVERAGE
 Floor System: 04 - WOOD W/ SUB FLOOR
 Roof Cover/Deck: 03 - COMPOSITION SHINGLE
 Floor Finish: 09 - HARDWOOD/PARQUE
 Paint/Decor: 03 - AVERAGE
 Electrical: 03 - AVERAGE
 Structural Frame: 00 - NONE

Building Areas

Areas	Square Feet
BAS - BASE	2,338
OPF - OPEN PORCH FINISHED	15
GRF - GARAGE FINISHED	580

Sale Information

Sale Date	Price	Book	Page	Vacant/Improved	Type Instrument	Qualification
6/13/2017	\$165,000	3247	1883	I - IMPROVED	WD - WARRANTY DEED	A - ACCEPTED
6/18/2012	\$173,000	3038	2139	I - IMPROVED	WD - WARRANTY DEED	A - ACCEPTED
11/18/2009	\$0	764	511		-	-
6/28/1999	\$163,000	443	182	I - IMPROVED	WD - WARRANTY DEED	A - ACCEPTED
10/18/1993	\$0	333	726		-	-