

Sullivan (082)
Tax Year 2026 | Reappraisal 2025

Jan 1 Owner
 JACOBS WILL MILLER &
 BLAIR ABELL WATSON
 623 5TH ST
 BRISTOL TN 37620

Current Owner

5TH ST 623
 Ctrl Map: 021H Group: D Parcel: 007.00 Pl: SI: 000

Value Information

Land Market Value: \$6,900
Improvement Value: \$85,400
Total Market Appraisal: \$92,300
Assessment Percentage: 40%
Assessment: \$36,920

Additional Information

General Information

Class: 08 - Commercial
City #: 090
Special Service District 1: 000
District: 17
Number of Buildings: 1
Utilities - Water/Sewer: 01 - PUBLIC / PUBLIC
Utilities - Gas/Gas Type: 01 - PUBLIC - NATURAL GAS

City: BRISTOL
Special Service District 2: 000
Neighborhood: B15
Number of Mobile Homes: 0
Utilities - Electricity: 01 - PUBLIC
Zoning:

Outbuildings & Yard Items

Building #	Type	Description	Area/Units
1	WDK - WOOD DECK	4X6	24
1	WDK - WOOD DECK	4X6	24

Sale Information

Long Sale Information list on subsequent pages

Land Information

Deed Acres: 0 **Calculated Acres:** .2 **Total Land Units:** 47

Land Code	Soil Class	Units
05 - MULTI FAMIY		47.00

Residential Building #: 1

Improvement Type:
 07 - RENTAL
Exterior Wall:
 04 - SIDING AVERAGE
Heat and AC:
 5 - HEATING W/DUCTS
Quality:
 1 - AVERAGE
Square Feet of Living Area:
 1451
Foundation:
 02 - CONTINUOUS FOOTING
Roof Framing:
 02 - GABLE/HIP
Cabinet/Millwork:
 03 - AVERAGE
Interior Finish:
 08 - PLASTERED DIRECT
Bath Tiles:
 00 - NONE
Shape:
 01 - RECTANGLE

Stories:
 1.00
Actual Year Built:
 1923
Plumbing Fixtures:
 6
Condition:
 AV - AVERAGE
Floor System:
 04 - WOOD W/ SUB FLOOR
Roof Cover/Deck:
 03 - COMPOSITION SHINGLE
Floor Finish:
 09 - HARDWOOD/PARQUE
Paint/Decor:
 03 - AVERAGE
Electrical:
 03 - AVERAGE
Structural Frame:
 00 - NONE

Building Sketch

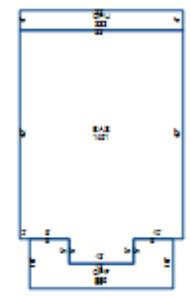

Building Areas

Areas	Square Feet
BAS - BASE	1,451
OPF - OPEN PORCH FINISHED	225
OPU - OPEN PORCH UNFINISHED	132

Sale Information

Sale Date	Price	Book	Page	Vacant/Improved	Type Instrument	Qualification
2/27/2025	\$115,000	3641	275	I - IMPROVED	WD - WARRANTY DEED	A - ACCEPTED
7/1/1991	\$0	307	444		-	-
9/16/1986	\$0	254	10		-	-
7/9/1985	\$0	239	170		-	-
4/3/1978	\$0	176	502		-	-