

Sullivan (082)
Tax Year 2026 | Reappraisal 2025

Jan 1 Owner
 LOWE LARRY & ELIZABETH
 161 KINGSBRIDGE
 BRISTOL TN 37620

Current Owner

MONTE VISTA ST 109
 Ctrl Map: 021J Group: H Parcel: 016.00 Pl: SI: 000

Value Information

Land Market Value: \$5,500
 Improvement Value: \$119,600
 Total Market Appraisal: \$125,100
 Assessment Percentage: 25%
 Assessment: \$31,275

Subdivision Data

Subdivision: FAIRMOUNT LAND CO
 Plat Book: 1 Plat Page: 55 Block: 36 Lot: P 7

Additional Information

General Information

Class: 00 - Residential City: BRISTOL
 City #: 090 Special Service District 2: 000
 Special Service District 1: 000 Neighborhood: B15
 District: 17 Number of Mobile Homes: 0
 Number of Buildings: 1 Utilities - Electricity: 01 - PUBLIC
 Utilities - Water/Sewer: 01 - PUBLIC / PUBLIC Zoning:
 Utilities - Gas/Gas Type: 00 - NONE

Outbuildings & Yard Items

Building #	Type	Description	Area/Units
------------	------	-------------	------------

Sale Information

Long Sale Information list on subsequent pages

Land Information

Deed Acres: 0	Calculated Acres: .07	Total Land Units: 0.07
Land Code	Soil Class	Units
01 - RES		0.07

Residential Building #: 1

Improvement Type: 51 - SINGLE FAMILY
 Exterior Wall: 04 - SIDING AVERAGE
 Heat and AC: 7 - HEAT AND COOLING SPLIT
 Quality: 1 - AVERAGE
 Square Feet of Living Area: 756
 Foundation: 02 - CONTINUOUS FOOTING
 Roof Framing: 02 - GABLE/HIP
 Cabinet/Millwork: 03 - AVERAGE
 Interior Finish: 07 - DRYWALL
 Bath Tiles: 00 - NONE
 Shape: 02 - L-SHAPED

Building Sketch

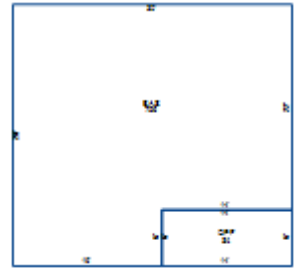

Stories: 1.00
 Actual Year Built: 2005
 Plumbing Fixtures: 3
 Condition: AV - AVERAGE
 Floor System: 04 - WOOD W/ SUB FLOOR
 Roof Cover/Deck: 03 - COMPOSITION SHINGLE
 Floor Finish: 11 - CARPET COMBINATION
 Paint/Decor: 03 - AVERAGE
 Electrical: 03 - AVERAGE
 Structural Frame: 00 - NONE

Building Areas

Areas	Square Feet
BAS - BASE	756
OPF - OPEN PORCH FINISHED	84

Sale Information

Sale Date	Price	Book	Page	Vacant/Improved	Type Instrument	Qualification
2/4/2022	\$70,000	3491	2171	I - IMPROVED	WD - WARRANTY DEED	P - MULTIPLE PARCELS
5/10/2016	\$0	3200	2361		-	-
4/21/2016	\$0	3196	1465		-	-
12/15/2005	\$0	652	256		-	-
10/10/1970	\$0	00134	00214		-	-