

Sullivan (082)
Tax Year 2026 | Reappraisal 2025

Jan 1 Owner
 MCCALLUM RICHARD D &
 BEVERLY JOINT TRUST
 532 TOT DELLINGER RD
 CHARLOTTE NC 28201

Current Owner

ROSCOMMON DR 216

Ctrl Map: 022G Group: C Parcel: 005.00 Pl: SI: 000

Value Information

Land Market Value: \$65,000
Improvement Value: \$640,800
Total Market Appraisal: \$705,800
Assessment Percentage: 25%
Assessment: \$176,450

Subdivision Data

Subdivision:
 TARA HILLS UNIT 2
Plat Book: 4 **Plat Page:** 3 **Block:** **Lot:** 167

Additional Information

General Information

Class: 00 - Residential
City #: 090
Special Service District 1: 000
District: 02
Number of Buildings: 1
Utilities - Water/Sewer: 03 - PUBLIC / INDIVIDUAL
Utilities - Gas/Gas Type: 01 - PUBLIC - NATURAL GAS

City: BRISTOL
Special Service District 2: 000
Neighborhood: B01
Number of Mobile Homes: 0
Utilities - Electricity: 01 - PUBLIC
Zoning:

Outbuildings & Yard Items

Long OutBuilding & Yard Items list on subsequent pages

Sale Information

Long Sale Information list on subsequent pages

Land Information

Deed Acres: 0 **Calculated Acres:** .52 **Total Land Units:** 0.52

| Land Code | Soil Class | Units |
|-----------|------------|-------|
| 01 - RES | | 0.52 |

Residential Building #: 1

Improvement Type:
 01 - SINGLE FAMILY
Exterior Wall:
 11 - COMMON BRICK
Heat and AC:
 7 - HEAT AND COOLING SPLIT
Quality:
 2 - ABOVE AVERAGE
Square Feet of Living Area:
 2883
Foundation:
 02 - CONTINUOUS FOOTING
Roof Framing:
 02 - GABLE/HIP
Cabinet/Millwork:
 04 - ABOVE AVG
Interior Finish:
 07 - DRYWALL
Bath Tiles:
 00 - NONE
Shape:
 02 - L-SHAPED

Stories:
 1.00
Actual Year Built:
 1999
Plumbing Fixtures:
 12
Condition:
 AV - AVERAGE
Floor System:
 04 - WOOD W/ SUB FLOOR
Roof Cover/Deck:
 03 - COMPOSITION SHINGLE
Floor Finish:
 11 - CARPET COMBINATION
Paint/Decor:
 04 - ABOVE AVERAGE
Electrical:
 04 - ABOVE AVG
Structural Frame:
 00 - NONE

Building Sketch

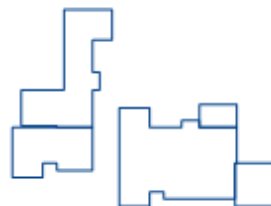

Building Areas

| Areas | Square Feet |
|-----------------------------|-------------|
| BAS - BASE | 2,883 |
| BMF - BASEMENT FINISHED | 1,116 |
| SPF - SCREEN PORCH FINISHED | 273 |
| GRF - GARAGE FINISHED | 600 |
| BMU - BASEMENT UNFINISHED | 1,767 |

Outbuildings & Yard Items

| Building # | Type | Description | Area/Units |
|------------|-----------------|-------------|------------|
| 1 | STP - STOOP | 4X8 | 32 |
| 1 | WDK - WOOD DECK | IRR | 345 |
| 1 | PTO - PATIO | 7X30 | 210 |

Sale Information

| Sale Date | Price | Book | Page | Vacant/Improved | Type Instrument | Qualification |
|-----------|----------|------|------|-----------------|---------------------|---------------|
| 6/6/2023 | \$0 | 3560 | 1678 | | QC - QUITCLAIM DEED | - |
| 7/15/1998 | \$26,000 | 421 | 338 | V - VACANT | WD - WARRANTY DEED | A - ACCEPTED |
| 8/18/1982 | \$0 | 212 | 121 | | - | - |
| 1/1/1982 | \$11,400 | 212 | 121 | V - VACANT | WD - WARRANTY DEED | A - ACCEPTED |