

Sullivan (082)
Tax Year 2026 | Reappraisal 2025

Jan 1 Owner
 KIMBLER EMMA KATE
 1904 SWEETBRIAR RD
 KINGSPORT TN 37665

Current Owner

SWEETBRIAR RD 1904

Ctrl Map: 029F Group: C Parcel: 003.10 Pl: SI: 000

Value Information

Land Market Value: \$6,500
 Improvement Value: \$147,400
 Total Market Appraisal: \$153,900
 Assessment Percentage: 25%
 Assessment: \$38,475

Subdivision Data

Subdivision: CHERRY HILL TRUCK FARM
 Plat Book: 41 Plat Page: 18 Block: Lot: 2

Additional Information

General Information

Class: 00 - Residential City: KINGSPORT
 City #: 380 Special Service District 2: 000
 Special Service District 1: 000 Neighborhood: K01
 District: 12 Number of Mobile Homes: 0
 Number of Buildings: 1 Utilities - Electricity: 01 - PUBLIC
 Utilities - Water/Sewer: 03 - PUBLIC / INDIVIDUAL Zoning:
 Utilities - Gas/Gas Type: 00 - NONE

Outbuildings & Yard Items

Building #	Type	Description	Area/Units
1	WDK - WOOD DECK	4X5	20
1	WDK - WOOD DECK	8X12	96

Sale Information

Long Sale Information list on subsequent pages

Land Information

Deed Acres: 0 Calculated Acres: .17 Total Land Units: 0.17

Land Code	Soil Class	Units
01 - RES		0.17

Residential Building #: 1

Improvement Type: 01 - SINGLE FAMILY
 Exterior Wall: 04 - SIDING AVERAGE
 Heat and AC: 7 - HEAT AND COOLING SPLIT
 Quality: 1 - AVERAGE
 Square Feet of Living Area: 1196
 Foundation: 02 - CONTINUOUS FOOTING
 Roof Framing: 02 - GABLE/HIP
 Cabinet/Millwork: 03 - AVERAGE
 Interior Finish: 07 - DRYWALL
 Bath Tiles: 00 - NONE
 Shape: 01 - RECTANGLE

Building Sketch

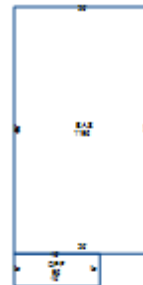

Stories:

1.00

Actual Year Built:

1997

Plumbing Fixtures:

5

Condition:

AV - AVERAGE

Floor System:

04 - WOOD W/ SUB FLOOR

Roof Cover/Deck:

03 - COMPOSITION SHINGLE

Floor Finish:

11 - CARPET COMBINATION

Paint/Decor:

03 - AVERAGE

Electrical:

03 - AVERAGE

Structural Frame:

00 - NONE

Building Areas

Areas	Square Feet
BAS - BASE	1,196
OPF - OPEN PORCH FINISHED	96

Sale Information

Sale Date	Price	Book	Page	Vacant/Improved	Type Instrument	Qualification
9/12/2025	\$0	3669	1914		QC - QUITCLAIM DEED	-
9/1/2022	\$0	3525	700		QC - QUITCLAIM DEED	-
6/27/2022	\$0	3518	441		QC - QUITCLAIM DEED	-
10/3/1997	\$39,000	1256C	172	I - IMPROVED	WD - WARRANTY DEED	A - ACCEPTED
12/8/1994	\$13,000	1036C	692	V - VACANT	WD - WARRANTY DEED	L - LIMITED
5/5/1989	\$8,950	668C	817	I - IMPROVED	WD - WARRANTY DEED	A - ACCEPTED
9/27/1976	\$0	102C	638		-	-