

Sullivan (082)
Tax Year 2026 | Reappraisal 2025

Jan 1 Owner
 BRS (TX) INVESTMENTS LLC
 2211 RAYFORD RD SUITE 111-339
 SPRING TX 77386-1555

Current Owner

EMMETT ST 225

Ctrl Map: 029L Group: C Parcel: 168.00 Pl: SI: 000

Value Information

Land Market Value: \$6,500
 Improvement Value: \$64,800
 Total Market Appraisal: \$71,300
 Assessment Percentage: 25%
 Assessment: \$17,825

Subdivision Data

Subdivision: IDA BARRETT PROP
 Plat Book: 3 Plat Page: 19 Block: Lot: 10

Additional Information

General Information

Class: 00 - Residential
 City #: 380
 Special Service District 1: 000
 District: 12
 Number of Buildings: 1
 Utilities - Water/Sewer: 01 - PUBLIC / PUBLIC
 Utilities - Gas/Gas Type: 00 - NONE

City: KINGSPORT
 Special Service District 2: 000
 Neighborhood: K01
 Number of Mobile Homes: 0
 Utilities - Electricity: 01 - PUBLIC
 Zoning: R-2

Outbuildings & Yard Items

Building #	Type	Description	Area/Units
1	CPY - CANOPY	3X8	24
1	WDK - WOOD DECK	3X8	24

Sale Information

Long Sale Information list on subsequent pages

Land Information

Deed Acres: 0 Calculated Acres: .17 Total Land Units: 0.17

Land Code	Soil Class	Units
01 - RES		0.17

Residential Building #: 1

Improvement Type: 01 - SINGLE FAMILY
 Exterior Wall: 04 - SIDING AVERAGE
 Heat and AC: 3 - RADIANT HEAT
 Quality: 0- - BELOW AVERAGE -
 Square Feet of Living Area: 1320
 Foundation: 01 - PIERS
 Roof Framing: 02 - GABLE/HIP
 Cabinet/Millwork: 02 - BELOW AVG
 Interior Finish: 11 - PANELING BELOW AVG
 Bath Tiles: 00 - NONE
 Shape: 01 - RECTANGLE

Stories: 1.00
 Actual Year Built: 1986
 Plumbing Fixtures: 3
 Condition: AV - AVERAGE
 Floor System: 03 - WOOD W/O SUB FLOOR
 Roof Cover/Deck: 03 - COMPOSITION SHINGLE
 Floor Finish: 11 - CARPET COMBINATION
 Paint/Decor: 03 - AVERAGE
 Electrical: 02 - BELOW AVG
 Structural Frame: 00 - NONE

Building Sketch

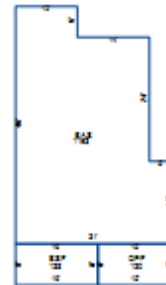

Building Areas

Areas	Square Feet
BAS - BASE	1,192
BSF - BASE SEMI FINISHED	128
OPF - OPEN PORCH FINISHED	120

Sale Information

Sale Date	Price	Book	Page	Vacant/Improved	Type Instrument	Qualification
3/2/2023	\$300,000	3547	1483	I - IMPROVED	WD - WARRANTY DEED	P - MULTIPLE PARCELS
5/10/2019	\$235,000	3333	190	I - IMPROVED	WD - WARRANTY DEED	P - MULTIPLE PARCELS
6/17/2013	\$187,500	3083	865	I - IMPROVED	WD - WARRANTY DEED	P - MULTIPLE PARCELS
12/3/1969	\$0	WB11	530		-	-
5/31/1956	\$0	169A	266		-	-