

Sullivan (082)
Tax Year 2026 | Reappraisal 2025

Jan 1 Owner
 RHOTON M SHEILA L/E &
 TRAVIS RHOTON R/M
 1233 FAIRVIEW AVE
 KINGSPORT TN 37660

Current Owner

FAIRVIEW AVE 1233

Ctrl Map: 029M Group: J Parcel: 022.00 Pl: SI: 000

Value Information

Land Market Value: \$7,500
Improvement Value: \$68,200
Total Market Appraisal: \$75,700
Assessment Percentage: 25%
Assessment: \$18,925

Subdivision Data

Subdivision:
 WEST VIEW PARK ADD
Plat Book: A **Plat Page:** 32 **Block:** 26 **Lot:** 9

Additional Information

General Information

Class: 00 - Residential **City:** KINGSPORT
City #: 380 **Special Service District 2:** 000
Special Service District 1: 000 **Neighborhood:** K01
District: 12 **Number of Mobile Homes:** 0
Number of Buildings: 1 **Utilities - Electricity:** 01 - PUBLIC
Utilities - Water/Sewer: 03 - PUBLIC / INDIVIDUAL **Zoning:** R-3A
Utilities - Gas/Gas Type: 00 - NONE

Outbuildings & Yard Items

Building #	Type	Description	Area/Units
1	PTO - PATIO	10X16	160
1	WDK - WOOD DECK	12X16	192

Sale Information

Long Sale Information list on subsequent pages

Land Information

Deed Acres: 0 **Calculated Acres:** .17 **Total Land Units:** 0.17

Land Code	Soil Class	Units
01 - RES		0.17

Residential Building #: 1

Improvement Type:
 51 - SINGLE FAMILY
Exterior Wall:
 04 - SIDING AVERAGE
Heat and AC:
 7 - HEAT AND COOLING SPLIT
Quality:
 1 - AVERAGE
Square Feet of Living Area:
 672
Foundation:
 02 - CONTINUOUS FOOTING
Roof Framing:
 02 - GABLE/HIP
Cabinet/Millwork:
 03 - AVERAGE
Interior Finish:
 11 - PANELING BELOW AVG
Bath Tiles:
 00 - NONE
Shape:
 01 - RECTANGLE

Stories:
 1.00
Actual Year Built:
 1913
Plumbing Fixtures:
 3
Condition:
 AV - AVERAGE
Floor System:
 04 - WOOD W/ SUB FLOOR
Roof Cover/Deck:
 03 - COMPOSITION SHINGLE
Floor Finish:
 11 - CARPET COMBINATION
Paint/Decor:
 03 - AVERAGE
Electrical:
 03 - AVERAGE
Structural Frame:
 00 - NONE

Building Sketch

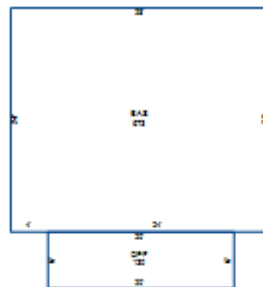

Building Areas

Areas	Square Feet
BAS - BASE	672
OPF - OPEN PORCH FINISHED	120

Sale Information

Sale Date	Price	Book	Page	Vacant/Improved	Type Instrument	Qualification
12/8/2000	\$0	2092C	30		-	-
8/13/1992	\$0	857C	312		-	-
9/30/1970	\$0	0349A	00216		-	-