

Sullivan (082)
Tax Year 2026 | Reappraisal 2025

Jan 1 Owner
 HOOD ALLYN
 151 CLAY ST
 KINGSPORT TN 37660

Current Owner

LOWELL DR 1910

Ctrl Map: 029N Group: C Parcel: 053.00 Pl: SI: 000

Value Information

Land Market Value: \$7,500
 Improvement Value: \$67,200
 Total Market Appraisal: \$74,700
 Assessment Percentage: 40%
 Assessment: \$29,880

Subdivision Data

Subdivision: WEST VIEW PARK ADD
 Plat Book: A Plat Page: 32 Block: 30 Lot: P 30

Additional Information

General Information

Class: 08 - Commercial City: KINGSPORT
 City #: 380 Special Service District 2: 000
 Special Service District 1: 000 Neighborhood: K01
 District: 12 Number of Mobile Homes: 0
 Number of Buildings: 1 Utilities - Electricity: 01 - PUBLIC
 Utilities - Water/Sewer: 03 - PUBLIC / INDIVIDUAL Zoning: R-1
 Utilities - Gas/Gas Type: 00 - NONE

Outbuildings & Yard Items

Building #	Type	Description	Area/Units
1	ASP - ASPHALT PAVING	20X40	800

Sale Information

Long Sale Information list on subsequent pages

Land Information

Deed Acres: 0 Calculated Acres: .2 Total Land Units: 76

Land Code	Soil Class	Units
10 - COM		76.00

Residential Building #: 1

Improvement Type: 01 - SINGLE FAMILY
 Exterior Wall: 03 - SIDING BELOW AVG
 Heat and AC: 0 - NONE
 Quality: 0 - BELOW AVERAGE
 Square Feet of Living Area: 1368
 Foundation: 03 - SPREAD FOOTING
 Roof Framing: 02 - GABLE/HIP
 Cabinet/Millwork: 02 - BELOW AVG
 Interior Finish: 07 - DRYWALL
 Bath Tiles: 00 - NONE
 Shape: 01 - RECTANGLE

Building Sketch

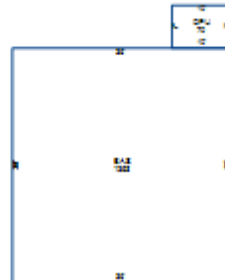

Stories: 1.00
 Actual Year Built: 1946
 Plumbing Fixtures: 3
 Condition: AV - AVERAGE
 Floor System: 01 - SLAB ON GRADE
 Roof Cover/Deck: 03 - COMPOSITION SHINGLE
 Floor Finish: 11 - CARPET COMBINATION
 Paint/Decor: 02 - BELOW AVERAGE
 Electrical: 02 - BELOW AVG
 Structural Frame: 00 - NONE

Building Areas

Areas	Square Feet
BAS - BASE	1,368
OPU - OPEN PORCH UNFINISHED	70

Sale Information

Sale Date	Price	Book	Page	Vacant/Improved	Type Instrument	Qualification
11/3/2014	\$33,000	3138	1821	I - IMPROVED	WD - WARRANTY DEED	P - MULTIPLE PARCELS
8/4/2014	\$0	3130	486		-	-
11/14/2002	\$0	1847C	469		-	-
8/8/1973	\$0	0042C	00390		-	-