

Sullivan (082)
Tax Year 2026 | Reappraisal 2025

Jan 1 Owner
 DOUGLAS THOMAS F & BETTY R
 803 GRAVELY RD
 KINGSPORT TN 37660

Current Owner

GRAVELY RD 803

Ctrl Map: 030F Group: B Parcel: 017.00 Pl: SI: 000

Value Information

Land Market Value: \$25,400
 Improvement Value: \$212,200
 Total Market Appraisal: \$237,600
 Assessment Percentage: 25%
 Assessment: \$59,400

Additional Information

General Information

Class: 00 - Residential
 City #:
 Special Service District 1: 000
 District: 11
 Number of Buildings: 1
 Utilities - Water/Sewer: 03 - PUBLIC / INDIVIDUAL
 Utilities - Gas/Gas Type: 00 - NONE

City:
 Special Service District 2: 000
 Neighborhood: K03
 Number of Mobile Homes: 0
 Utilities - Electricity: 01 - PUBLIC
 Zoning: R-1

Outbuildings & Yard Items

Long OutBuilding & Yard Items list on subsequent pages

Sale Information

Long Sale Information list on subsequent pages

Land Information

Deed Acres: 0 Calculated Acres: 1.08 Total Land Units: 1.08

Land Code	Soil Class	Units
01 - RES		1.08

Residential Building #: 1

Improvement Type:
 01 - SINGLE FAMILY
Exterior Wall:
 04 - SIDING AVERAGE
Heat and AC:
 7 - HEAT AND COOLING SPLIT
Quality:
 1 - AVERAGE
Square Feet of Living Area:
 1560
Foundation:
 02 - CONTINUOUS FOOTING
Roof Framing:
 02 - GABLE/HIP
Cabinet/Millwork:
 03 - AVERAGE
Interior Finish:
 07 - DRYWALL
Bath Tiles:
 00 - NONE
Shape:
 01 - RECTANGLE

Stories:
 1.00
Actual Year Built:
 1940
Plumbing Fixtures:
 3
Condition:
 AV - AVERAGE
Floor System:
 04 - WOOD W/ SUB FLOOR
Roof Cover/Deck:
 13 - PREFIN METAL CRIMPED
Floor Finish:
 11 - CARPET COMBINATION
Paint/Decor:
 03 - AVERAGE
Electrical:
 03 - AVERAGE
Structural Frame:
 00 - NONE

Building Sketch

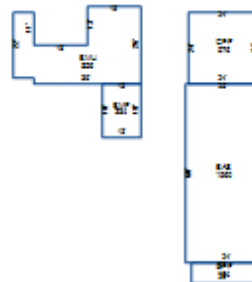

Building Areas

Areas	Square Feet
BAS - BASE	1,560
BMF - BASEMENT FINISHED	234
OPF - OPEN PORCH FINISHED	154
CPF - CARPORT FINISHED	576
BMU - BASEMENT UNFINISHED	856

Outbuildings & Yard Items

Building #	Type	Description	Area/Units
1	GUD - DETACHED GARAGE UNFINISHED	29X31	899
1	POL - SWIMMING POOL	16X32	512
1	WDK - WOOD DECK	7X14	91

Sale Information

Sale Date	Price	Book	Page	Vacant/Improved	Type Instrument	Qualification
8/24/2015	\$0	3171	1147		-	-
7/15/1999	\$0	1441C	631		-	-
10/30/1995	\$74,500	1096C	165	I - IMPROVED	WD - WARRANTY DEED	P - MULTIPLE PARCELS
2/23/1973	\$0	0390A	00385		-	-