

Sullivan (082)
Tax Year 2026 | Reappraisal 2025

Jan 1 Owner
 BENNETT GREGORY D
 1460 RIDGECREST AVE
 KINGSPORT TN 37660

Current Owner

GRAVELY RD 497

Ctrl Map: 030H Group: G Parcel: 029.00 Pl: SI: 000

Value Information

Land Market Value: \$16,900
Improvement Value: \$111,800
Total Market Appraisal: \$128,700
Assessment Percentage: 25%
Assessment: \$32,175

Subdivision Data

Subdivision:
 RESUB TRS 5-10 GRAVELLY TR
Plat Book: **Plat Page:** **Block:** **Lot:**
 1 180A P 42

Additional Information

General Information

Class: 00 - Residential **City:** KINGSPORT
City #: 380 **Special Service District 2:** 000
Special Service District 1: 000 **Neighborhood:** K01
District: 11 **Number of Mobile Homes:** 0
Number of Buildings: 1 **Utilities - Electricity:** 01 - PUBLIC
Utilities - Water/Sewer: 03 - PUBLIC / INDIVIDUAL **Zoning:** R-1
Utilities - Gas/Gas Type: 00 - NONE

Outbuildings & Yard Items

Building #	Type	Description	Area/Units
1	CPY - CANOPY	10X32	320
1	CPY - CANOPY	16X20	320

Sale Information

Long Sale Information list on subsequent pages

Land Information

Deed Acres: 0 **Calculated Acres:** 1.01 **Total Land Units:** 1.01

Land Code	Soil Class	Units
01 - RES		1.01

Residential Building #: 1

Improvement Type:
 01 - SINGLE FAMILY
Exterior Wall:
 04 - SIDING AVERAGE
Heat and AC:
 7 - HEAT AND COOLING SPLIT
Quality:
 1 - AVERAGE
Square Feet of Living Area:
 1152
Foundation:
 02 - CONTINUOUS FOOTING
Roof Framing:
 02 - GABLE/HIP
Cabinet/Millwork:
 03 - AVERAGE
Interior Finish:
 11 - PANELING BELOW AVG
Bath Tiles:
 00 - NONE
Shape:
 00 - SQUARE

Stories:
 1.00
Actual Year Built:
 1956
Plumbing Fixtures:
 3
Condition:
 AV - AVERAGE
Floor System:
 04 - WOOD W/ SUB FLOOR
Roof Cover/Deck:
 03 - COMPOSITION SHINGLE
Floor Finish:
 09 - HARDWOOD/PARQUE
Paint/Decor:
 03 - AVERAGE
Electrical:
 03 - AVERAGE
Structural Frame:
 00 - NONE

Building Sketch

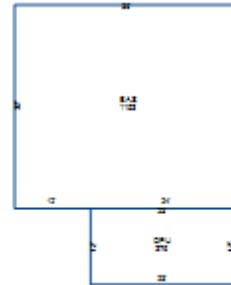

Building Areas

Areas	Square Feet
BAS - BASE	1,152
OPU - OPEN PORCH UNFINISHED	276

Sale Information

Sale Date	Price	Book	Page	Vacant/Improved	Type Instrument	Qualification
7/17/2013	\$0	3087	190		-	-
10/22/2002	\$120,000	1837C	304	I - IMPROVED	WD - WARRANTY DEED	P - MULTIPLE PARCELS
2/26/1952	\$0	0168A	00078		-	-