

**Sullivan (082)**  
**Tax Year 2026 | Reappraisal 2025**

Jan 1 Owner  
 WOLFE TONY J & PAMELA B  
 1200 LE AMRON DR  
 KINGSPORT TN 37665

Current Owner

**LE AMRON DR 1200**  
 Ctrl Map: 030J    Group: A    Parcel: 004.00    Pl:    SI: 000

**Value Information**

**Land Market Value:** \$24,800  
**Improvement Value:** \$599,000  
**Total Market Appraisal:** \$623,800  
**Assessment Percentage:** 25%  
**Assessment:** \$155,950

**Additional Information**

**General Information**

**Class:** 00 - Residential  
**City #:**  
**Special Service District 1:** 000  
**District:** 11  
**Number of Buildings:** 1  
**Utilities - Water/Sewer:** 00 - PUBLIC / NONE  
**Utilities - Gas/Gas Type:** 00 - NONE

**City:**  
**Special Service District 2:** 000  
**Neighborhood:** K03  
**Number of Mobile Homes:** 0  
**Utilities - Electricity:** 01 - PUBLIC  
**Zoning:** R-1

**Outbuildings & Yard Items**

Long OutBuilding & Yard Items list on subsequent pages

**Sale Information**

Long Sale Information list on subsequent pages

**Land Information**

<b>Deed Acres:</b> 3.93	<b>Calculated Acres:</b>	<b>Total Land Units:</b> 3.93	
Land Code	Soil Class		Units
01 - RES			3.93

**Residential Building #: 1**

**Improvement Type:**  
 01 - SINGLE FAMILY  
**Exterior Wall:**  
 11 - COMMON BRICK  
**Heat and AC:**  
 7 - HEAT AND COOLING SPLIT  
**Quality:**  
 1 - AVERAGE  
**Square Feet of Living Area:**  
 3890  
**Foundation:**  
 02 - CONTINUOUS FOOTING  
**Roof Framing:**  
 02 - GABLE/HIP  
**Cabinet/Millwork:**  
 03 - AVERAGE  
**Interior Finish:**  
 07 - DRYWALL  
**Bath Tiles:**  
 00 - NONE  
**Shape:**  
 02 - L-SHAPED

**Stories:**  
 2.00  
**Actual Year Built:**  
 2000  
**Plumbing Fixtures:**  
 11  
**Condition:**  
 AV - AVERAGE  
**Floor System:**  
 04 - WOOD W/ SUB FLOOR  
**Roof Cover/Deck:**  
 03 - COMPOSITION SHINGLE  
**Floor Finish:**  
 11 - CARPET COMBINATION  
**Paint/Decor:**  
 03 - AVERAGE  
**Electrical:**  
 03 - AVERAGE  
**Structural Frame:**  
 00 - NONE

**Building Sketch**

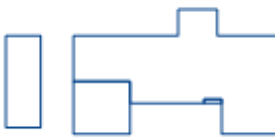

**Building Areas**

Areas	Square Feet
BAS - BASE	3,218
USF - UPPER STORY FINISHED	672
OPF - OPEN PORCH FINISHED	16
GRF - GARAGE FINISHED	624

**Outbuildings & Yard Items**

Building #	Type	Description	Area/Units
1	PTO - PATIO	16X42	672
1	POL - SWIMMING POOL	18X36	648
1	PTO - PATIO	IRR	882

**Sale Information**

Sale Date	Price	Book	Page	Vacant/Improved	Type Instrument	Qualification
6/22/2017	\$230,000	3248	701		-	-
5/11/1984	\$0	416C	116		-	-
11/22/1935	\$0	31A	192		-	-