

Sullivan (082)
Tax Year 2026 | Reappraisal 2025

Jan 1 Owner
 ADAMS EARL & MARTHA S
 1214 PEBBLE DRIVE
 KINGSPORT TN 37660

Current Owner

PEBBLE DR 1214

Ctrl Map: 030J Group: B Parcel: 004.00 Pl: SI: 000

Value Information

Land Market Value: \$18,000
 Improvement Value: \$113,200
 Total Market Appraisal: \$131,200
 Assessment Percentage: 25%
 Assessment: \$32,800

Subdivision Data

Subdivision: KINGSPORT CORP J S SHIPP
 Plat Book: 2 Plat Page: 53A- Block: 2 Lot: 23

Additional Information

General Information

Class: 00 - Residential City #: City: Special Service District 2: 000
 Special Service District 1: 000 Neighborhood: K03
 District: 11 Number of Mobile Homes: 0
 Number of Buildings: 1 Utilities - Electricity: 01 - PUBLIC
 Utilities - Water/Sewer: 03 - PUBLIC / INDIVIDUAL Zoning: R-1
 Utilities - Gas/Gas Type: 00 - NONE

Outbuildings & Yard Items

Building #	Type	Description	Area/Units
1	WDK - WOOD DECK	16X23	368

Sale Information

Long Sale Information list on subsequent pages

Land Information

Deed Acres: 0 Calculated Acres: .79 Total Land Units: 0.79

Land Code	Soil Class	Units
01 - RES		0.79

Residential Building #: 1

Improvement Type: 51 - SINGLE FAMILY
 Exterior Wall: 04 - SIDING AVERAGE
 Heat and AC: 7 - HEAT AND COOLING SPLIT
 Quality: 1 - AVERAGE
 Square Feet of Living Area: 900
 Foundation: 02 - CONTINUOUS FOOTING
 Roof Framing: 02 - GABLE/HIP
 Cabinet/Millwork: 03 - AVERAGE
 Interior Finish: 11 - PANELING BELOW AVG
 Bath Tiles: 00 - NONE
 Shape: 01 - RECTANGLE

Stories: 1.00
 Actual Year Built: 1953
 Plumbing Fixtures: 3
 Condition: AV - AVERAGE
 Floor System: 04 - WOOD W/ SUB FLOOR
 Roof Cover/Deck: 13 - PREFIN METAL CRIMPED
 Floor Finish: 11 - CARPET COMBINATION
 Paint/Decor: 03 - AVERAGE
 Electrical: 03 - AVERAGE
 Structural Frame: 00 - NONE

Building Sketch

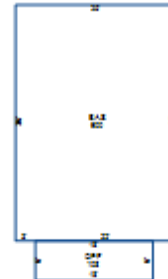

Building Areas

Areas	Square Feet
BAS - BASE	900
OPF - OPEN PORCH FINISHED	108

Sale Information

Sale Date	Price	Book	Page	Vacant/Improved	Type Instrument	Qualification
8/30/1995	\$40,000	1083C	31	I - IMPROVED	WD - WARRANTY DEED	A - ACCEPTED
5/20/1993	\$39,900	915C	110	I - IMPROVED	WD - WARRANTY DEED	A - ACCEPTED
10/31/1991	\$0	814C	576		-	-
3/6/1987	\$0	545C	476		-	-