

Sullivan (082)
Tax Year 2026 | Reappraisal 2025

Jan 1 Owner
 SALYER MARY E L/E &
 QUENTIN KORDELL SALYER R/M
 350 GIBBS RD
 KINGSPORT TN 37660

Current Owner

GIBBS RD 350

Ctrl Map: 030J Group: C Parcel: 009.00 Pl: SI: 000

Value Information

Land Market Value: \$13,900
Improvement Value: \$217,100
Total Market Appraisal: \$231,000
Assessment Percentage: 25%
Assessment: \$57,750

Subdivision Data

Subdivision:
 KINGSPORT CORP J S SHIPP
Plat Book: 2 **Plat Page:** 53A- **Block:** 1 **Lot:** 9

Additional Information

General Information

Class: 00 - Residential **City:**
City #: **Special Service District 2:** 000
Special Service District 1: 000 **Neighborhood:** K03
District: 11 **Number of Mobile Homes:** 0
Number of Buildings: 1 **Utilities - Electricity:** 01 - PUBLIC
Utilities - Water/Sewer: 03 - PUBLIC / INDIVIDUAL **Zoning:** R-2
Utilities - Gas/Gas Type: 00 - NONE

Outbuildings & Yard Items

Building #	Type	Description	Area/Units
1	WDK - WOOD DECK	4X4	16
1	WDK - WOOD DECK	16X16	256

Sale Information

Long Sale Information list on subsequent pages

Land Information

Deed Acres: 0 **Calculated Acres:** .39 **Total Land Units:** 0.39

Land Code	Soil Class	Units
01 - RES		0.39

Residential Building #: 1

Improvement Type:
 01 - SINGLE FAMILY
Exterior Wall:
 04 - SIDING AVERAGE
Heat and AC:
 7 - HEAT AND COOLING SPLIT
Quality:
 1 - AVERAGE
Square Feet of Living Area:
 1424
Foundation:
 02 - CONTINUOUS FOOTING
Roof Framing:
 02 - GABLE/HIP
Cabinet/Millwork:
 03 - AVERAGE
Interior Finish:
 07 - DRYWALL
Bath Tiles:
 00 - NONE
Shape:
 01 - RECTANGLE

Stories:
 1.00
Actual Year Built:
 2003
Plumbing Fixtures:
 6
Condition:
 AV - AVERAGE
Floor System:
 04 - WOOD W/ SUB FLOOR
Roof Cover/Deck:
 13 - PREFIN METAL CRIMPED
Floor Finish:
 09 - HARDWOOD/PARQUE
Paint/Decor:
 03 - AVERAGE
Electrical:
 03 - AVERAGE
Structural Frame:
 00 - NONE

Building Sketch

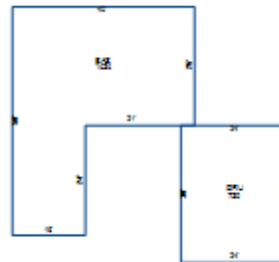

Building Areas

Areas	Square Feet
BAS - BASE	1,424
GRU - GARAGE UNFINISHED	720

Sale Information

Sale Date	Price	Book	Page	Vacant/Improved	Type Instrument	Qualification
7/26/2016	\$0	3214	718		QC - QUITCLAIM DEED	-
3/12/2004	\$0	2085C	340		-	-
7/2/2003	\$0	1965C	450		-	-
8/25/1999	\$10,000	1453C	262	I - IMPROVED	WD - WARRANTY DEED	A - ACCEPTED
8/24/1989	\$0	685C	5331		-	-