

Sullivan (082)
Tax Year 2026 | Reappraisal 2025

Jan 1 Owner
 BROWNING JOHN F & RUBY J
 1920 DERTING ST
 KINGSPORT TN 37660

Current Owner

DERTING ST 1920

Ctrl Map: 030L Group: D Parcel: 012.00 Pl: SI: 000

Value Information

Land Market Value: \$14,100
 Improvement Value: \$185,000
 Total Market Appraisal: \$199,100
 Assessment Percentage: 25%
 Assessment: \$49,775

Subdivision Data

Subdivision: JOHN BROWNING PROP REV
 Plat Book: 51 Plat Page: 555 Block: Lot: 1 A

Additional Information

General Information

Class: 00 - Residential
 City #: City:
 Special Service District 1: 000
 District: 11
 Number of Buildings: 1
 Utilities - Water/Sewer: 01 - PUBLIC / PUBLIC
 Utilities - Gas/Gas Type: 00 - NONE

City:
 Special Service District 2: 000
 Neighborhood: K03
 Number of Mobile Homes: 0
 Utilities - Electricity: 01 - PUBLIC
 Zoning: R-1

Outbuildings & Yard Items

Building #	Type	Description	Area/Units
1	GUD - DETACHED GARAGE UNFINISHED	28X32	896
1	STP - STOOP	4X17	68

Sale Information

Sale Date	Price	Book	Page	Vacant/Improved	Type Instrument	Qualification
4/3/1974	\$0	0023C	00680		-	-

Land Information

Deed Acres: 0.77 Calculated Acres: 0 Total Land Units: 0.77

Land Code	Soil Class	Units
01 - RES		0.77

Residential Building #: 1

Improvement Type: 01 - SINGLE FAMILY
 Exterior Wall: 12 - BRICK/WOOD
 Heat and AC: 7 - HEAT AND COOLING SPLIT
 Quality: 1 - AVERAGE
 Square Feet of Living Area: 1385
 Foundation: 02 - CONTINUOUS FOOTING
 Roof Framing: 02 - GABLE/HIP
 Cabinet/Millwork: 03 - AVERAGE
 Interior Finish: 07 - DRYWALL
 Bath Tiles: 00 - NONE
 Shape: 01 - RECTANGLE

Building Sketch

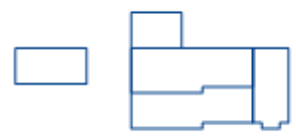

Stories:

1.00
Actual Year Built: 1959
Plumbing Fixtures: 6
Condition: AV - AVERAGE
Floor System: 04 - WOOD W/ SUB FLOOR
Roof Cover/Deck: 13 - PREFIN METAL CRIMPED
Floor Finish: 11 - CARPET COMBINATION
Paint/Decor: 03 - AVERAGE
Electrical: 03 - AVERAGE
Structural Frame: 00 - NONE

Building Areas

Areas	Square Feet
BAS - BASE	1,073
BSF - BASE SEMI FINISHED	312
BMF - BASEMENT FINISHED	288
BMU - BASEMENT UNFINISHED	785