

**Sullivan (082)**  
**Tax Year 2026 | Reappraisal 2025**

Jan 1 Owner  
 MCCORD DONNA MARIE &  
 OSCAR EUGENE HAYES  
 2441 PONDELLA AVE  
 KINGSPORT TN 37660

Current Owner

**PONDELLA AVE 2441**  
 Ctrl Map: 031G    Group: B    Parcel: 009.05    Pl:    SI: 000

**Value Information**

**Land Market Value:** \$13,700  
**Improvement Value:** \$152,800  
**Total Market Appraisal:** \$166,500  
**Assessment Percentage:** 25%  
**Assessment:** \$41,625

**Subdivision Data**

**Subdivision:**  
 RAMEY SUB  
**Plat Book:** 5    **Plat Page:** 158    **Block:** 7    **Lot:** PT10

**Additional Information**

**General Information**

**Class:** 00 - Residential  
**City #:**  
**Special Service District 1:** 000  
**District:** 10  
**Number of Buildings:** 1  
**Utilities - Water/Sewer:** 01 - PUBLIC / PUBLIC  
**Utilities - Gas/Gas Type:** 01 - PUBLIC - NATURAL GAS

**City:**  
**Special Service District 2:** 000  
**Neighborhood:** A01  
**Number of Mobile Homes:** 0  
**Utilities - Electricity:** 01 - PUBLIC  
**Zoning:** R-1

**Outbuildings & Yard Items**

Building #	Type	Description	Area/Units
1	WDK - WOOD DECK	12X20	240

**Sale Information**

Long Sale Information list on subsequent pages

**Land Information**

<b>Deed Acres:</b> 0	<b>Calculated Acres:</b> .35	<b>Total Land Units:</b> 0.36
Land Code	Soil Class	Units
01 - RES		0.36

**Residential Building #: 1**

**Improvement Type:**  
 51 - SINGLE FAMILY  
**Exterior Wall:**  
 04 - SIDING AVERAGE  
**Heat and AC:**  
 8 - HEAT AND COOLING PKG  
**Quality:**  
 1 - AVERAGE  
**Square Feet of Living Area:**  
 899  
**Foundation:**  
 02 - CONTINUOUS FOOTING  
**Roof Framing:**  
 02 - GABLE/HIP  
**Cabinet/Millwork:**  
 03 - AVERAGE  
**Interior Finish:**  
 07 - DRYWALL  
**Bath Tiles:**  
 00 - NONE  
**Shape:**  
 00 - SQUARE

**Stories:**  
 1.00  
**Actual Year Built:**  
 1948  
**Plumbing Fixtures:**  
 4  
**Condition:**  
 AV - AVERAGE  
**Floor System:**  
 04 - WOOD W/ SUB FLOOR  
**Roof Cover/Deck:**  
 13 - PREFIN METAL CRIMPED  
**Floor Finish:**  
 09 - HARDWOOD/PARQUE  
**Paint/Decor:**  
 03 - AVERAGE  
**Electrical:**  
 03 - AVERAGE  
**Structural Frame:**  
 00 - NONE

**Building Sketch**

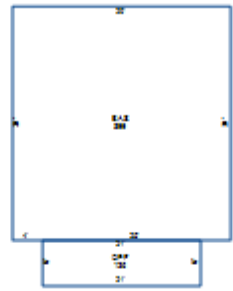

**Building Areas**

Areas	Square Feet
BAS - BASE	899
OPF - OPEN PORCH FINISHED	126

**Sale Information**

<b>Sale Date</b>	<b>Price</b>	<b>Book</b>	<b>Page</b>	<b>Vacant/Improved</b>	<b>Type Instrument</b>	<b>Qualification</b>
10/29/2021	\$110,000	3475	2396	I - IMPROVED	WD - WARRANTY DEED	A - ACCEPTED
2/27/1997	\$20,000	1200C	47	I - IMPROVED	WD - WARRANTY DEED	B - FAMILY SALE
1/12/1993	\$20,000	952C	385	I - IMPROVED	WD - WARRANTY DEED	A - ACCEPTED