

**Sullivan (082)**  
**Tax Year 2026 | Reappraisal 2025**

Jan 1 Owner  
 WILLIAMS BLAKE ISAAC &  
 PAYTON MADISON  
 2076 SHARRON RD  
 KINGSPORT TN 37660

Current Owner

**SHARRON RD 2076**  
 Ctrl Map: 031H    Group: A    Parcel: 026.00    Pl:    SI: 000

**Value Information**

**Land Market Value:** \$22,600  
**Improvement Value:** \$306,500  
**Total Market Appraisal:** \$329,100  
**Assessment Percentage:** 25%  
**Assessment:** \$82,275

**Subdivision Data**

**Subdivision:** STUFFLE HEIGHTS ADDN #3  
**Plat Book:** 15    **Plat Page:** 4    **Block:** E    **Lot:** 7

**Additional Information**

**General Information**

**Class:** 00 - Residential    **City:**  
**City #:**    **Special Service District 2:** 000  
**Special Service District 1:** 000    **Neighborhood:** K03  
**District:** 11    **Number of Mobile Homes:** 0  
**Number of Buildings:** 1    **Utilities - Electricity:** 01 - PUBLIC  
**Utilities - Water/Sewer:** 03 - PUBLIC / INDIVIDUAL    **Zoning:** R-1  
**Utilities - Gas/Gas Type:** 00 - NONE

**Outbuildings & Yard Items**

Long OutBuilding & Yard Items list on subsequent pages

**Sale Information**

Long Sale Information list on subsequent pages

**Land Information**

<b>Deed Acres:</b> 0	<b>Calculated Acres:</b> .49	<b>Total Land Units:</b> 0.49
Land Code	Soil Class	Units
01 - RES		0.49

**Residential Building #: 1**

**Improvement Type:**  
 01 - SINGLE FAMILY  
**Exterior Wall:**  
 04 - SIDING AVERAGE  
**Heat and AC:**  
 7 - HEAT AND COOLING SPLIT  
**Quality:**  
 1 - AVERAGE  
**Square Feet of Living Area:**  
 1639  
**Foundation:**  
 02 - CONTINUOUS FOOTING  
**Roof Framing:**  
 02 - GABLE/HIP  
**Cabinet/Millwork:**  
 03 - AVERAGE  
**Interior Finish:**  
 07 - DRYWALL  
**Bath Tiles:**  
 00 - NONE  
**Shape:**  
 01 - RECTANGLE

**Building Sketch**

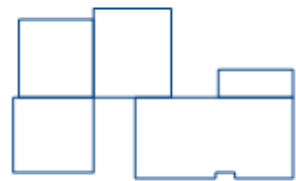

**Stories:**  
 1.00  
**Actual Year Built:**  
 1979  
**Plumbing Fixtures:**  
 8  
**Condition:**  
 AV - AVERAGE  
**Floor System:**  
 04 - WOOD W/ SUB FLOOR  
**Roof Cover/Deck:**  
 13 - PREFIN METAL CRIMPED  
**Floor Finish:**  
 09 - HARDWOOD/PARQUE  
**Paint/Decor:**  
 03 - AVERAGE  
**Electrical:**  
 03 - AVERAGE  
**Structural Frame:**  
 00 - NONE

**Building Areas**

Areas	Square Feet
BAS - BASE	1,639
BMF - BASEMENT FINISHED	783
EPF - ENCLOSED PORCH FINISHED	270
BMU - BASEMENT UNFINISHED	756
GRU - GARAGE UNFINISHED	896

**Outbuildings & Yard Items**

Building #	Type	Description	Area/Units
1	WDK - WOOD DECK	10X14	140
1	STP - STOOP	4X8	32
1	UTB - UTILITY BUILDING	12X16	192
1	CPY - CANOPY	12X20	240

**Sale Information**

Sale Date	Price	Book	Page	Vacant/Improved	Type Instrument	Qualification
4/11/2025	\$362,500	3647	2739	I - IMPROVED	WD - WARRANTY DEED	P - MULTIPLE PARCELS
9/11/1981	\$0	298C	249		-	-
3/18/1981	\$0	278C	533		-	-
1/1/1981	\$58,000	298C	249	I - IMPROVED	WD - WARRANTY DEED	A - ACCEPTED
3/6/1979	\$0	200C	756		-	-