

Sullivan (082)
Tax Year 2026 | Reappraisal 2025

Jan 1 Owner
 WEBB WILEY EARL JR &
 MARLENA KAY WEBB
 208 JONESBORO RD
 BRISTOL TN 37620

Current Owner

BLUFF CITY HWY 190
 Ctrl Map: 037D Group: D Parcel: 003.00 Pl: SI: 000

Value Information

Land Market Value: \$49,200
Improvement Value: \$128,200
Total Market Appraisal: \$177,400
Assessment Percentage: 40%
Assessment: \$70,960

Additional Information

General Information

Class: 08 - Commercial
City #: 090
Special Service District 1: 000
District: 17
Number of Buildings: 2
Utilities - Water/Sewer: 01 - PUBLIC / PUBLIC
Utilities - Gas/Gas Type: 00 - NONE

City: BRISTOL
Special Service District 2: 000
Neighborhood: B15
Number of Mobile Homes: 0
Utilities - Electricity: 01 - PUBLIC
Zoning:

Outbuildings & Yard Items

Building #	Type	Description	Area/Units
------------	------	-------------	------------

Sale Information

Long Sale Information list on subsequent pages

Land Information

Deed Acres: 0 **Calculated Acres:** .21 **Total Land Units:** 149

Land Code	Soil Class	Units
10 - COM		149.00

Commercial Building #: 1

Improvement Type:
 30 - OFFICE
Quality:
 0- - BELOW AVERAGE -
Foundation:
 02 - CONTINUOUS FOOTING
Roof Framing:
 02 - GABLE/HIP
Cabinet/Millwork:
 02 - BELOW AVG
Interior Finish:
 08 - PLASTERED DIRECT
Bath Tiles:
 00 - NONE
Shape:
 01 - RECTANGLE
Heat and AC:
 03 - RADIANT HEAT
Building Sketch

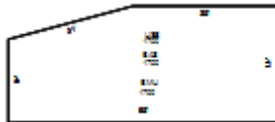

Actual Year Built:
 1950
Business Living Area:
 5100
Floor System:
 04 - WOOD W/ SUB FLOOR
Roof Cover/Deck:
 03 - COMPOSITION SHINGLE
Floor Finish:
 11 - CARPET COMBINATION
Paint/Decor:
 03 - AVERAGE
Electrical:
 03 - AVERAGE
Structural Frame:
 00 - NONE
Plumbing Fixtures:
 12
Interior/Exterior Areas

Type	Square Feet	Exterior Wall
30 - OFFICE	1,700	11 - COMMON BRICK
BMU - Basement unfinished	1,700	11 - COMMON BRICK
30 - OFFICE	1,700	11 - COMMON BRICK

Commercial Features

Type	Units
UTF - UTILITY FINISHED	980 X 1

Commercial Building #: 2

Improvement Type:

20 - STORE

Quality:

0- - BELOW AVERAGE -

Foundation:

02 - CONTINUOUS FOOTING

Roof Framing:

00 - FLAT

Cabinet/Millwork:

00 - NONE

Interior Finish:

02 - CEILING FIN ONLY MIN

Bath Tiles:

00 - NONE

Shape:

01 - RECTANGLE

Heat and AC:

00 - NONE

Building Sketch

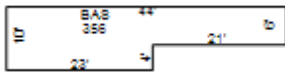

Actual Year Built:

1955

Business Living Area:

356

Floor System:

01 - SLAB ON GRADE

Roof Cover/Deck:

09 - BUILT-UP WOOD

Floor Finish:

01 - CONCRETE FINISH

Paint/Decor:

02 - BELOW AVERAGE

Electrical:

02 - BELOW AVG

Structural Frame:

00 - NONE

Plumbing Fixtures:

2

Interior/Exterior Areas

Type	Square Feet	Exterior Wall
20 - STORE	356	07 - CONCRETE BLOCK

Commercial Features

Type	Units
------	-------

Sale Information

Sale Date	Price	Book	Page	Vacant/Improved	Type Instrument	Qualification
12/22/2023	\$0	3587	1426		QC - QUITCLAIM DEED	-
12/22/2023	\$0	3587	1422		QC - QUITCLAIM DEED	-
9/30/1984	\$0	231	336		-	-
1/30/1976	\$0	158	375		-	-
11/6/1946	\$0	83	44		-	-
1/1/1900	\$0	NA	NA		-	-