

**Sullivan (082)**  
**Tax Year 2026 | Reappraisal 2025**

Jan 1 Owner  
 Current Owner  
 CUNNINGHAM HEATHER &  
 BRYAN F ARNOLD  
 7 CROWN CIR  
 BRISTOL TN 37620

**CROWN CIR 7**  
 Ctrl Map: 038A    Group: H    Parcel: 025.00    Pl:    SI: 000

**Value Information**

**Land Market Value:** \$25,600  
**Improvement Value:** \$384,700  
**Total Market Appraisal:** \$410,300  
**Assessment Percentage:** 25%  
**Assessment:** \$102,575

**Subdivision Data**

**Subdivision:** ELMWOOD ADD  
**Plat Book:** 1    **Plat Page:** 223    **Block:** 3    **Lot:** 4

**Additional Information**

**General Information**

**Class:** 00 - Residential    **City:** BRISTOL  
**City #:** 090    **Special Service District 2:** 000  
**Special Service District 1:** 000    **Neighborhood:** B01  
**District:** 17    **Number of Mobile Homes:** 0  
**Number of Buildings:** 1    **Utilities - Electricity:** 01 - PUBLIC  
**Utilities - Water/Sewer:** 01 - PUBLIC / PUBLIC  
**Utilities - Gas/Gas Type:** 00 - NONE  
**Zoning:**

**Outbuildings & Yard Items**

Building #	Type	Description	Area/Units
1	WDK - WOOD DECK	6X14	84
1	WDK - WOOD DECK	16X18	288

**Sale Information**

Long Sale Information list on subsequent pages

**Land Information**

**Deed Acres:** 0    **Calculated Acres:** 0.73    **Total Land Units:** 0.73

Land Code	Soil Class	Units
01 - RES		0.73

**Residential Building #: 1**

**Improvement Type:** 01 - SINGLE FAMILY  
**Exterior Wall:** 12 - BRICK/WOOD  
**Heat and AC:** 7 - HEAT AND COOLING SPLIT  
**Quality:** 1 - AVERAGE  
**Square Feet of Living Area:** 3903  
**Foundation:** 02 - CONTINUOUS FOOTING  
**Roof Framing:** 02 - GABLE/HIP  
**Cabinet/Millwork:** 03 - AVERAGE  
**Interior Finish:** 07 - DRYWALL  
**Bath Tiles:** 00 - NONE  
**Shape:** 01 - RECTANGLE

**Building Sketch**

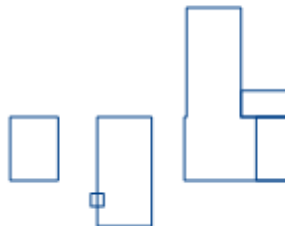

**Stories:** 1.00  
**Actual Year Built:** 1954  
**Plumbing Fixtures:** 9  
**Condition:** AV - AVERAGE  
**Floor System:** 04 - WOOD W/ SUB FLOOR  
**Roof Cover/Deck:** 03 - COMPOSITION SHINGLE  
**Floor Finish:** 11 - CARPET COMBINATION  
**Paint/Decor:** 03 - AVERAGE  
**Electrical:** 03 - AVERAGE  
**Structural Frame:** 00 - NONE

**Building Areas**

Areas	Square Feet
BAS - BASE	2,671
BSF - BASE SEMI FINISHED	1,232
BMF - BASEMENT FINISHED	464
EPF - ENCLOSED PORCH FINISHED	276
OPF - OPEN PORCH FINISHED	18
BMU - BASEMENT UNFINISHED	638

**Sale Information**

<b>Sale Date</b>	<b>Price</b>	<b>Book</b>	<b>Page</b>	<b>Vacant/Improved</b>	<b>Type Instrument</b>	<b>Qualification</b>
1/11/2019	\$218,000	3319	117	I - IMPROVED	WD - WARRANTY DEED	A - ACCEPTED
9/9/2004	\$80,600	606	764	I - IMPROVED	WD - WARRANTY DEED	A - ACCEPTED
11/3/1967	\$0	00127	00216		-	-