

**Sullivan (082)**  
**Tax Year 2026 | Reappraisal 2025**

Jan 1 Owner  
 SHI ZHONGSHOU &  
 QIAO XIA SHEN  
 108 HALEY WALK  
 BRISTOL TN 37620

Current Owner  
**HALEY WALK 108**  
 Ctrl Map: 038D    Group: E    Parcel: 002.00    Pl:    SI: 000

**Value Information**

**Land Market Value:** \$27,200  
**Improvement Value:** \$341,900  
**Total Market Appraisal:** \$369,100  
**Assessment Percentage:** 25%  
**Assessment:** \$92,275

**Subdivision Data**

**Subdivision:**  
 DEER CREEK AT FAIRFIELD  
**Plat Book:** 7    **Plat Page:** 226    **Block:**    **Lot:** 2

**Additional Information**

**General Information**

**Class:** 00 - Residential    **City:** BRISTOL  
**City #:** 090    **Special Service District 2:** 000  
**Special Service District 1:** 000    **Neighborhood:** B01  
**District:** 02    **Number of Mobile Homes:** 0  
**Number of Buildings:** 1    **Utilities - Electricity:** 01 - PUBLIC  
**Utilities - Water/Sewer:** 03 - PUBLIC / INDIVIDUAL  
**Utilities - Gas/Gas Type:** 00 - NONE  
**Zoning:**

**Outbuildings & Yard Items**

Building #	Type	Description	Area/Units
1	WDK - WOOD DECK	8X47	376

**Sale Information**

Long Sale Information list on subsequent pages

**Land Information**

**Deed Acres:** 0.34    **Calculated Acres:** .35    **Total Land Units:** 0.35

Land Code	Soil Class	Units
01 - RES		0.35

**Residential Building #: 1**

**Improvement Type:**  
 01 - SINGLE FAMILY  
**Exterior Wall:**  
 04 - SIDING AVERAGE  
**Heat and AC:**  
 7 - HEAT AND COOLING SPLIT  
**Quality:**  
 2- - ABOVE AVERAGE -  
**Square Feet of Living Area:**  
 1960  
**Foundation:**  
 02 - CONTINUOUS FOOTING  
**Roof Framing:**  
 02 - GABLE/HIP  
**Cabinet/Millwork:**  
 04 - ABOVE AVG  
**Interior Finish:**  
 07 - DRYWALL  
**Bath Tiles:**  
 00 - NONE  
**Shape:**  
 03 - U-SHAPED

**Building Sketch**

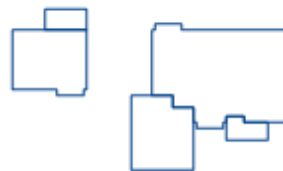

**Stories:**  
 2.00  
**Actual Year Built:**  
 2005  
**Plumbing Fixtures:**  
 10  
**Condition:**  
 AV - AVERAGE  
**Floor System:**  
 04 - WOOD W/ SUB FLOOR  
**Roof Cover/Deck:**  
 03 - COMPOSITION SHINGLE  
**Floor Finish:**  
 11 - CARPET COMBINATION  
**Paint/Decor:**  
 04 - ABOVE AVERAGE  
**Electrical:**  
 04 - ABOVE AVG  
**Structural Frame:**  
 00 - NONE

**Building Areas**

Areas	Square Feet
BAS - BASE	1,383
USF - UPPER STORY FINISHED	518
OPF - OPEN PORCH FINISHED	96
GRF - GARAGE FINISHED	497
USH - UPPER STORY HIGH	98

**Sale Information**

<b>Sale Date</b>	<b>Price</b>	<b>Book</b>	<b>Page</b>	<b>Vacant/Improved</b>	<b>Type Instrument</b>	<b>Qualification</b>
10/28/2016	\$205,000	3220	1410	I - IMPROVED	WD - WARRANTY DEED	A - ACCEPTED
11/30/2005	\$183,500	649	142	I - IMPROVED	WD - WARRANTY DEED	A - ACCEPTED
3/18/2005	\$25,000	623	341	V - VACANT	WD - WARRANTY DEED	A - ACCEPTED
7/22/2004	\$97,500	602	173	V - VACANT	WD - WARRANTY DEED	P - MULTIPLE PARCELS
5/24/2002	\$0	521	36		-	-