

Sullivan (082)
Tax Year 2026 | Reappraisal 2025

Jan 1 Owner
 FERGUSON STEPHEN THOMAS
 538 RIVERSIDE AVE
 KINGSPORT TN 37660

Current Owner

RIVERSIDE AVE 538

Ctrl Map: 045E Group: E Parcel: 022.00 Pl: SI: 000

Value Information

Land Market Value: \$15,000
Improvement Value: \$123,000
Total Market Appraisal: \$138,000
Assessment Percentage: 25%
Assessment: \$34,500

Subdivision Data

Subdivision:
 SUNBERG SUB
Plat Book: A **Plat Page:** 65 **Block:** 2 **Lot:** 13

Additional Information

General Information

Class: 00 - Residential
City #: 380
Special Service District 1: 000
District: 11
Number of Buildings: 1
Utilities - Water/Sewer: 01 - PUBLIC / PUBLIC
Utilities - Gas/Gas Type: 00 - NONE

City: KINGSPORT
Special Service District 2: 000
Neighborhood: K01
Number of Mobile Homes: 0
Utilities - Electricity: 01 - PUBLIC
Zoning:

Outbuildings & Yard Items

Building #	Type	Description	Area/Units
1	WDK - WOOD DECK	IRR	136
1	PTO - PATIO	5X33	165

Sale Information

Long Sale Information list on subsequent pages

Land Information

Deed Acres: 0 **Calculated Acres:** .2 **Total Land Units:** 0.2

Land Code	Soil Class	Units
01 - RES		0.20

Residential Building #: 1

Improvement Type:
 01 - SINGLE FAMILY
Exterior Wall:
 04 - SIDING AVERAGE
Heat and AC:
 7 - HEAT AND COOLING SPLIT
Quality:
 1 - AVERAGE
Square Feet of Living Area:
 1350
Foundation:
 02 - CONTINUOUS FOOTING
Roof Framing:
 02 - GABLE/HIP
Cabinet/Millwork:
 03 - AVERAGE
Interior Finish:
 11 - PANELING BELOW AVG
Bath Tiles:
 00 - NONE
Shape:
 01 - RECTANGLE

Building Sketch

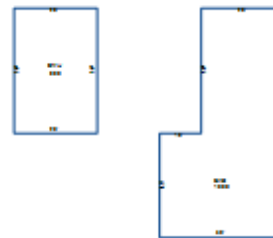

Stories:
 1.00
Actual Year Built:
 1920
Plumbing Fixtures:
 3
Condition:
 AV - AVERAGE
Floor System:
 04 - WOOD W/ SUB FLOOR
Roof Cover/Deck:
 03 - COMPOSITION SHINGLE
Floor Finish:
 09 - HARDWOOD/PARQUE
Paint/Decor:
 03 - AVERAGE
Electrical:
 03 - AVERAGE
Structural Frame:
 00 - NONE

Building Areas

Areas	Square Feet
BAS - BASE	1,350
BMU - BASEMENT UNFINISHED	600

Sale Information

Sale Date	Price	Book	Page	Vacant/Improved	Type Instrument	Qualification
6/16/1994	\$0	1004C	177		-	-
11/5/1985	\$0	468C	164		-	-
9/1/1977	\$0	137C	775		-	-
4/12/1977	\$0	124C	247		-	-