

Sullivan (082)
Tax Year 2026 | Reappraisal 2025

Jan 1 Owner
 CAP SNAP COMPANY
 % PORTOLA PACKAGING INC
 408 TILTHAMMER DR
 KINGSPORT TN 37664

Current Owner

TILTHAMMER DR 408
 Ctrl Map: 045N Group: A Parcel: 003.00 Pl: SI: 000

Value Information

Land Market Value: \$170,100
Improvement Value: \$2,163,800
Total Market Appraisal: \$2,333,900
Assessment Percentage: 40%
Assessment: \$933,560

Subdivision Data

Subdivision: RIDGEFIELDS IND PARK
Plat Book: 9 **Plat Page:** 48 **Block:** **Lot:** 7

Additional Information

SILGAN CLOSURES

General Information

Class: 09 - Industrial **City:** KINGSPORT
City #: 380 **Special Service District 2:** 000
Special Service District 1: 000 **Neighborhood:** K40
District: 12 **Number of Mobile Homes:** 0
Number of Buildings: 1 **Utilities - Electricity:** 01 - PUBLIC
Utilities - Water/Sewer: 01 - PUBLIC / PUBLIC **Zoning:**
Utilities - Gas/Gas Type: 01 - PUBLIC - NATURAL GAS

Outbuildings & Yard Items

Building #	Type	Description	Area/Units
1	ASP - ASPHALT PAVING	IRR	31,000
1	CNC - CONCRETE PAVING	IRR	4,100

Sale Information

Long Sale Information list on subsequent pages

Land Information

Deed Acres:	Calculated Acres:	Total Land Units:
3.06	0	3.06
Land Code	Soil Class	Units
10 - COM		3.06

Commercial Building #: 1

Improvement Type: 44 - LIGHT MFG
Quality: 1+ - AVERAGE +
Foundation: 03 - SPREAD FOOTING
Roof Framing: 06 - STEEL TRUSS/PURLINS
Cabinet/Millwork: 00 - NONE
Interior Finish: 01 - UNFINISHED
Bath Tiles: 00 - NONE
Shape: 01 - RECTANGLE
Heat and AC: 00 - NONE
Building Sketch

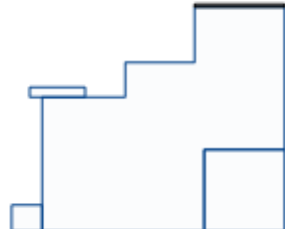

Actual Year Built: 1976
Business Living Area: 90684
Floor System: 01 - SLAB ON GRADE
Roof Cover/Deck: 13 - PREFIN METAL CRIMPED
Floor Finish: 01 - CONCRETE FINISH
Paint/Decor: 03 - AVERAGE
Electrical: 04 - ABOVE AVG
Structural Frame: 02 - MASONRY PIL/STL
Plumbing Fixtures: 18
Interior/Exterior Areas

Type	Square Feet	Exterior Wall
44 - LIGHT MFG	75,644	19 - PREFIN METAL CRIMPED
OFA - Office - Average	1,584	19 - PREFIN METAL CRIMPED
OFA - Office - Average	13,456	19 - PREFIN METAL CRIMPED

Commercial Features

Type	Units
UTF - UTILITY FINISHED	1120 X 1
HAC - HEATING AND COOLING	31272 X 1
SPR - SPRINKLER SYSTEM	69712 X 1
CAW - CANOPY	520 X 1

Sale Information

Sale Date	Price	Book	Page	Vacant/Improved	Type Instrument	Qualification
1/13/1986	\$0	476C	279		-	-
1/27/1976	\$0	79C	359		-	-
10/2/1975	\$0	66C	252		-	-