

Sullivan (082)
Tax Year 2026 | Reappraisal 2025

Jan 1 Owner
 ULEMINCKX ALICIA
 2124 HEATHERLY RD
 KINGSPORT TN 37660

Current Owner

HEATHERLY RD 2124
 Ctrl Map: 0450 Group: C Parcel: 003.00 Pl: SI: 000

Value Information

Land Market Value: \$29,600
Improvement Value: \$329,800
Total Market Appraisal: \$359,400
Assessment Percentage: 25%
Assessment: \$89,850

Subdivision Data

Subdivision: RIDGEFIELDS SUB
Plat Book: 7 **Plat Page:** 85 **Block:** 18 **Lot:** 3

Additional Information

General Information

Class: 00 - Residential
City #: 380
Special Service District 1: 000
District: 12
Number of Buildings: 1
Utilities - Water/Sewer: 01 - PUBLIC / PUBLIC
Utilities - Gas/Gas Type: 01 - PUBLIC - NATURAL GAS

City: KINGSPORT
Special Service District 2: 000
Neighborhood: K01
Number of Mobile Homes: 0
Utilities - Electricity: 01 - PUBLIC
Zoning:

Outbuildings & Yard Items

Long OutBuilding & Yard Items list on subsequent pages

Sale Information

Long Sale Information list on subsequent pages

Land Information

Deed Acres: 0	Calculated Acres: .46	Total Land Units: 0.46
Land Code	Soil Class	Units
01 - RES		0.46

Residential Building #: 1

Improvement Type: 01 - SINGLE FAMILY
Exterior Wall: 11 - COMMON BRICK
Heat and AC: 7 - HEAT AND COOLING SPLIT
Quality: 1 - AVERAGE
Square Feet of Living Area: 2520
Foundation: 02 - CONTINUOUS FOOTING
Roof Framing: 02 - GABLE/HIP
Cabinet/Millwork: 03 - AVERAGE
Interior Finish: 07 - DRYWALL
Bath Tiles: 00 - NONE
Shape: 01 - RECTANGLE

Stories: 1.00
Actual Year Built: 1963
Plumbing Fixtures: 8
Condition: AV - AVERAGE
Floor System: 04 - WOOD W/ SUB FLOOR
Roof Cover/Deck: 03 - COMPOSITION SHINGLE
Floor Finish: 11 - CARPET COMBINATION
Paint/Decor: 03 - AVERAGE
Electrical: 03 - AVERAGE
Structural Frame: 00 - NONE

Building Sketch

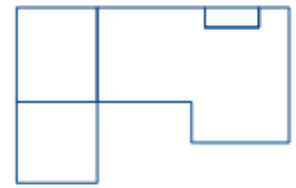

Building Areas

Areas	Square Feet
BAS - BASE	1,848
BSF - BASE SEMI FINISHED	672
SPF - SCREEN PORCH FINISHED	96
GRF - GARAGE FINISHED	576

Outbuildings & Yard Items

Building #	Type	Description	Area/Units
1	PTO - PATIO	10X16	160
1	PTO - PATIO	IRR	648
1	POL - SWIMMING POOL	15X34	510
1	PUO - OPEN PORCH UNFINISHED	12X16	192

Sale Information

Sale Date	Price	Book	Page	Vacant/Improved	Type Instrument	Qualification
4/7/2009	\$150,000	2763C	401	I - IMPROVED	WD - WARRANTY DEED	A - ACCEPTED
9/29/2008	\$122,683	2747C	536	I - IMPROVED	WD - WARRANTY DEED	G - FORCED SALE
9/16/2005	\$156,000	2308C	302	I - IMPROVED	WD - WARRANTY DEED	A - ACCEPTED
9/29/2000	\$149,000	1566C	167	I - IMPROVED	WD - WARRANTY DEED	A - ACCEPTED