

**Sullivan (082)**  
**Tax Year 2026 | Reappraisal 2025**

Jan 1 Owner  
 HANSEN HANNAH GALE &  
 RICHARD ANDREW HANSEN  
 156 ROSEFIELD DR  
 KINGSPORT TN 37660

Current Owner

**ROSEFIELD DR 156**

Ctrl Map: 046B    Group: D    Parcel: 003.00    Pl:    SI: 000

**Value Information**

**Land Market Value:** \$27,700  
**Improvement Value:** \$222,700  
**Total Market Appraisal:** \$250,400  
**Assessment Percentage:** 25%  
**Assessment:** \$62,600

**Subdivision Data**

**Subdivision:** BLOOMINGTON HGTS  
**Plat Book:** 7    **Plat Page:** 123    **Block:** B    **Lot:** 9

**Additional Information**

**General Information**

**Class:** 00 - Residential    **City:** KINGSPORT  
**City #:** 380    **Special Service District 2:** 000  
**Special Service District 1:** 000    **Neighborhood:** K01  
**District:** 11    **Number of Mobile Homes:** 0  
**Number of Buildings:** 1    **Utilities - Electricity:** 01 - PUBLIC  
**Utilities - Water/Sewer:** 03 - PUBLIC / INDIVIDUAL    **Zoning:**  
**Utilities - Gas/Gas Type:** 00 - NONE

**Outbuildings & Yard Items**

Building #	Type	Description	Area/Units
1	UTB - UTILITY BUILDING	8X8	64
1	PTO - PATIO	8X11	88

**Sale Information**

Long Sale Information list on subsequent pages

**Land Information**

**Deed Acres:** 0    **Calculated Acres:** .38    **Total Land Units:** 0.38

Land Code	Soil Class	Units
01 - RES		0.38

**Residential Building #: 1**

**Improvement Type:** 01 - SINGLE FAMILY  
**Exterior Wall:** 11 - COMMON BRICK  
**Heat and AC:** 7 - HEAT AND COOLING SPLIT  
**Quality:** 1 - AVERAGE  
**Square Feet of Living Area:** 1710  
**Foundation:** 02 - CONTINUOUS FOOTING  
**Roof Framing:** 02 - GABLE/HIP  
**Cabinet/Millwork:** 03 - AVERAGE  
**Interior Finish:** 07 - DRYWALL  
**Bath Tiles:** 00 - NONE  
**Shape:** 01 - RECTANGLE

**Building Sketch**

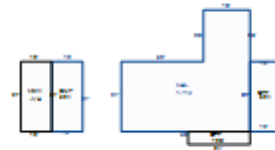

**Stories:**

1.00  
**Actual Year Built:** 1963

**Plumbing Fixtures:**

9  
**Condition:** AV - AVERAGE

**Floor System:**

04 - WOOD W/ SUB FLOOR

**Roof Cover/Deck:**

03 - COMPOSITION SHINGLE

**Floor Finish:**

11 - CARPET COMBINATION

**Paint/Decor:**

03 - AVERAGE

**Electrical:**

03 - AVERAGE

**Structural Frame:**

00 - NONE

**Building Areas**

Areas	Square Feet
BAS - BASE	1,710
BMF - BASEMENT FINISHED	324
CPF - CARPORT FINISHED	324
BMU - BASEMENT UNFINISHED	324
OPF - OPEN PORCH FINISHED	120

**Sale Information**

<b>Sale Date</b>	<b>Price</b>	<b>Book</b>	<b>Page</b>	<b>Vacant/Improved</b>	<b>Type Instrument</b>	<b>Qualification</b>
12/4/2023	\$325,000	3585	834	I - IMPROVED	WD - WARRANTY DEED	J - ESTATE SALE
9/9/2013	\$0	3094	333		-	-
5/25/2004	\$0	2116C	507		-	-
2/4/1953	\$0	0229A	00281		-	-