

Sullivan (082)
Tax Year 2026 | Reappraisal 2025

Jan 1 Owner
 GALENTINE DAYDREAM LLC
 12538 S ANTHONY EXT
 FORT WAYNE IN 46819

Current Owner

GIBSON MILL RD 1102

Ctrl Map: 046G Group: B Parcel: 006.00 Pl: SI: 000

Value Information

Land Market Value: \$9,300
 Improvement Value: \$61,300
 Total Market Appraisal: \$70,600
 Assessment Percentage: 25%
 Assessment: \$17,650

Subdivision Data

Subdivision: BAKER PROP DIVISION
 Plat Book: 59 Plat Page: 490 Block: Lot: 8R

Additional Information

RESUB

General Information

Class: 00 - Residential City: KINGSPORT
 City #: 380 Special Service District 2: 000
 Special Service District 1: 000 Neighborhood: K01
 District: 11 Number of Mobile Homes: 0
 Number of Buildings: 1 Utilities - Electricity: 01 - PUBLIC
 Utilities - Water/Sewer: 01 - PUBLIC / PUBLIC
 Utilities - Gas/Gas Type: 00 - NONE Zoning:

Outbuildings & Yard Items

| Building # | Type | Description | Area/Units |
|------------|------|-------------|------------|
|------------|------|-------------|------------|

Sale Information

Long Sale Information list on subsequent pages

Land Information

Deed Acres: 0.12 Calculated Acres: Total Land Units: 0.12

| Land Code | Soil Class | Units |
|-----------|------------|-------|
| 01 - RES | | 0.12 |

Residential Building #: 1

Improvement Type: 51 - SINGLE FAMILY
 Exterior Wall: 04 - SIDING AVERAGE
 Heat and AC: 3 - RADIANT HEAT
 Quality: 0+ - BELOW AVERAGE +
 Square Feet of Living Area: 848
 Foundation: 02 - CONTINUOUS FOOTING
 Roof Framing: 02 - GABLE/HIP
 Cabinet/Millwork: 02 - BELOW AVG
 Interior Finish: 07 - DRYWALL
 Bath Tiles: 00 - NONE
 Shape: 01 - RECTANGLE

Building Sketch

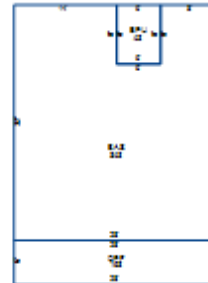

Stories: 1.00
 Actual Year Built: 1937
 Plumbing Fixtures: 3
 Condition: AV - AVERAGE
 Floor System: 04 - WOOD W/ SUB FLOOR
 Roof Cover/Deck: 03 - COMPOSITION SHINGLE
 Floor Finish: 08 - PINE/SOFT WOOD
 Paint/Decor: 02 - BELOW AVERAGE
 Electrical: 02 - BELOW AVG
 Structural Frame: 00 - NONE

Building Areas

| Areas | Square Feet |
|---------------------------------|-------------|
| BAS - BASE | 848 |
| OPF - OPEN PORCH FINISHED | 168 |
| EPU - ENCLOSED PORCH UNFINISHED | 48 |

Sale Information

| Sale Date | Price | Book | Page | Vacant/Improved | Type Instrument | Qualification |
|------------------|--------------|-------------|-------------|------------------------|-------------------------|----------------------|
| 11/13/2024 | \$24,000 | 3629 | 2481 | I - IMPROVED | WD - WARRANTY DEED | A - ACCEPTED |
| 11/6/2024 | \$0 | 3628 | 2907 | | DC - DEED OF CORRECTION | - |
| 6/28/2024 | \$65,000 | 3612 | 641 | I - IMPROVED | WD - WARRANTY DEED | P - MULTIPLE PARCELS |
| 4/13/2011 | \$0 | 2963C | 7 | | - | - |
| 3/11/1954 | \$0 | 0148A | 00145 | | - | - |