

**Sullivan (082)**  
**Tax Year 2026 | Reappraisal 2025**

Jan 1 Owner  
 BISHOP SUSAN S  
 1089 ROTHERWOOD DR  
 KINGSPORT TN 37660

Current Owner

**CEDAR ST 109**

Ctrl Map: 046G    Group: B    Parcel: 027.00    Pl:    SI: 000

**Value Information**

Land Market Value: \$8,600  
 Improvement Value: \$92,600  
 Total Market Appraisal: \$101,200  
 Assessment Percentage: 25%  
 Assessment: \$25,300

**Subdivision Data**

Subdivision: CEDAR VIEW ADD  
 Plat Book: A    Plat Page: 30A-    Block: 1    Lot: 4

**Additional Information**

**General Information**

Class: 00 - Residential  
 City #: 380  
 Special Service District 1: 000  
 District: 11  
 Number of Buildings: 1  
 Utilities - Water/Sewer: 01 - PUBLIC / PUBLIC  
 Utilities - Gas/Gas Type: 00 - NONE

City: KINGSPORT  
 Special Service District 2: 000  
 Neighborhood: K01  
 Number of Mobile Homes: 0  
 Utilities - Electricity: 01 - PUBLIC  
 Zoning:

**Outbuildings & Yard Items**

Building #	Type	Description	Area/Units
------------	------	-------------	------------

**Sale Information**

Long Sale Information list on subsequent pages

**Land Information**

Deed Acres: 0    Calculated Acres: .11    Total Land Units: 0.11

Land Code	Soil Class	Units
01 - RES		0.11

**Residential Building #: 1**

Improvement Type: 51 - SINGLE FAMILY  
 Exterior Wall: 04 - SIDING AVERAGE  
 Heat and AC: 7 - HEAT AND COOLING SPLIT  
 Quality: 1 - AVERAGE  
 Square Feet of Living Area: 952  
 Foundation: 02 - CONTINUOUS FOOTING  
 Roof Framing: 02 - GABLE/HIP  
 Cabinet/Millwork: 02 - BELOW AVG  
 Interior Finish: 11 - PANELING BELOW AVG  
 Bath Tiles: 00 - NONE  
 Shape: 01 - RECTANGLE

Stories: 1.00  
 Actual Year Built: 1933  
 Plumbing Fixtures: 3  
 Condition: AV - AVERAGE  
 Floor System: 04 - WOOD W/ SUB FLOOR  
 Roof Cover/Deck: 13 - PREFIN METAL CRIMPED  
 Floor Finish: 11 - CARPET COMBINATION  
 Paint/Decor: 03 - AVERAGE  
 Electrical: 03 - AVERAGE  
 Structural Frame: 00 - NONE

**Building Sketch**

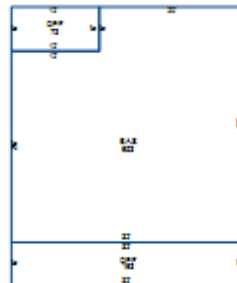

**Building Areas**

Areas	Square Feet
BAS - BASE	952
OPF - OPEN PORCH FINISHED	192
OPF - OPEN PORCH FINISHED	72

**Sale Information**

<b>Sale Date</b>	<b>Price</b>	<b>Book</b>	<b>Page</b>	<b>Vacant/Improved</b>	<b>Type Instrument</b>	<b>Qualification</b>
3/23/2017	\$18,991	3237	365	I - IMPROVED	WD - WARRANTY DEED	N - NON-ARM'S LENGTH
5/5/2004	\$29,800	2160C	445	I - IMPROVED	WD - WARRANTY DEED	A - ACCEPTED
10/1/1992	\$0	868C	684		-	-
7/21/1992	\$12,800	852C	466	I - IMPROVED	WD - WARRANTY DEED	A - ACCEPTED
4/28/1989	\$19,500	668C	145	I - IMPROVED	WD - WARRANTY DEED	A - ACCEPTED