

Sullivan (082)
Tax Year 2026 | Reappraisal 2025

Jan 1 Owner
 CAIN JACOB R & RACHEL H
 417 CORALWOOD DR
 KINGSPORT TN 37663

Current Owner

SEWANEE AVE 319

Ctrl Map: 046H Group: D Parcel: 010.00 Pl: SI: 000

Value Information

Land Market Value: \$14,300
Improvement Value: \$62,400
Total Market Appraisal: \$76,700
Assessment Percentage: 25%
Assessment: \$19,175

Subdivision Data

Subdivision: CHEROKEE VILLAGE
Plat Book: 2 **Plat Page:** 99 **Block:** 7 **Lot:** 84X

Additional Information

General Information

Class: 00 - Residential **City:** KINGSPORT
City #: 380 **Special Service District 2:** 000
Special Service District 1: 000 **Neighborhood:** K01
District: 11 **Number of Mobile Homes:** 0
Number of Buildings: 1 **Utilities - Electricity:** 01 - PUBLIC
Utilities - Water/Sewer: 01 - PUBLIC / PUBLIC **Zoning:**
Utilities - Gas/Gas Type: 01 - PUBLIC - NATURAL GAS

Outbuildings & Yard Items

Building #	Type	Description	Area/Units
1	CPY - CANOPY	IRR	296
1	UTB - UTILITY BUILDING	4X10	40

Sale Information

Long Sale Information list on subsequent pages

Land Information

Deed Acres: 0 **Calculated Acres:** .19 **Total Land Units:** 0.19

Land Code	Soil Class	Units
01 - RES		0.19

Residential Building #: 1

Improvement Type: 51 - SINGLE FAMILY
Exterior Wall: 12 - BRICK/WOOD
Heat and AC: 7 - HEAT AND COOLING SPLIT
Quality: 1 - AVERAGE
Square Feet of Living Area: 731
Foundation: 02 - CONTINUOUS FOOTING
Roof Framing: 02 - GABLE/HIP
Cabinet/Millwork: 03 - AVERAGE
Interior Finish: 07 - DRYWALL
Bath Tiles: 00 - NONE
Shape: 01 - RECTANGLE

Building Sketch

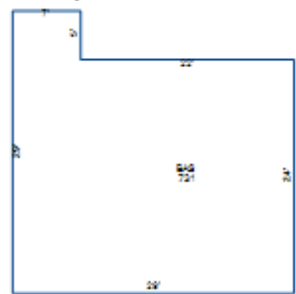

Stories:

1.00

Actual Year Built:

1943

Plumbing Fixtures:

3

Condition:

AV - AVERAGE

Floor System:

01 - SLAB ON GRADE

Roof Cover/Deck:

03 - COMPOSITION SHINGLE

Floor Finish:

11 - CARPET COMBINATION

Paint/Decor:

03 - AVERAGE

Electrical:

03 - AVERAGE

Structural Frame:

00 - NONE

Building Areas

Areas	Square Feet
BAS - BASE	731

Sale Information

Sale Date	Price	Book	Page	Vacant/Improved	Type Instrument	Qualification
6/28/2019	\$90,000	3339	1695	I - IMPROVED	WD - WARRANTY DEED	P - MULTIPLE PARCELS
7/17/2002	\$0	1794C	423		-	-
5/21/1999	\$0	1427C	440		-	-
4/22/1991	\$0	770C	666		-	-
7/31/1985	\$0	455C	368		-	-