

Sullivan (082)
Tax Year 2026 | Reappraisal 2025

Jan 1 Owner
 REYNOLDS PAUL & DEBRA L
 1333 BELMEADE DR
 KINGSPORT TN 37664

Current Owner

BELMEADE DR 1333

Ctrl Map: 046K Group: H Parcel: 004.00 Pl: SI: 000

Value Information

Land Market Value: \$62,600
Improvement Value: \$247,700
Total Market Appraisal: \$310,300
Assessment Percentage: 25%
Assessment: \$77,575

Subdivision Data

Subdivision:
 FAIRACRES
Plat Book: **Plat Page:** **Block:** **Lot:**
 1 90A M 10

Additional Information

General Information

Class: 00 - Residential **City:** KINGSPORT
City #: 380 **Special Service District 2:** 000
Special Service District 1: 000 **Neighborhood:** K01
District: 11 **Number of Mobile Homes:** 0
Number of Buildings: 1 **Utilities - Electricity:** 01 - PUBLIC
Utilities - Water/Sewer: 01 - PUBLIC / PUBLIC **Zoning:**
Utilities - Gas/Gas Type: 01 - PUBLIC - NATURAL
 GAS

Outbuildings & Yard Items

Long OutBuilding & Yard Items list on subsequent pages

Sale Information

Long Sale Information list on subsequent pages

Land Information

Deed Acres: 0 **Calculated Acres:** .69 **Total Land Units:** 0.69

Land Code	Soil Class	Units
01 - RES		0.69

Residential Building #: 1

Improvement Type:
 01 - SINGLE FAMILY
Exterior Wall:
 04 - SIDING AVERAGE
Heat and AC:
 7 - HEAT AND COOLING SPLIT
Quality:
 1 - AVERAGE
Square Feet of Living Area:
 2241
Foundation:
 02 - CONTINUOUS FOOTING
Roof Framing:
 02 - GABLE/HIP
Cabinet/Millwork:
 03 - AVERAGE
Interior Finish:
 07 - DRYWALL
Bath Tiles:
 00 - NONE
Shape:
 03 - U-SHAPED

Building Sketch

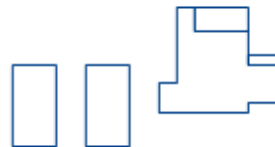

Stories:

2.00

Actual Year Built:

1937

Plumbing Fixtures:

6

Condition:

AV - AVERAGE

Floor System:

04 - WOOD W/ SUB FLOOR

Roof Cover/Deck:

03 - COMPOSITION SHINGLE

Floor Finish:

11 - CARPET COMBINATION

Paint/Decor:

03 - AVERAGE

Electrical:

03 - AVERAGE

Structural Frame:

00 - NONE

Building Areas

Areas	Square Feet
BAS - BASE	2,061
OPF - OPEN PORCH FINISHED	324
OPF - OPEN PORCH FINISHED	90
BMU - BASEMENT UNFINISHED	902
ATF - ATTIC FINISHED	902

Outbuildings & Yard Items

Building #	Type	Description	Area/Units
1	STP - STOOP	5X6	30
1	WDK - WOOD DECK	IRR	392
1	PTO - PATIO	8X24	192
1	GUD - DETACHED GARAGE UNFINISHED	28X32	896

Sale Information

Sale Date	Price	Book	Page	Vacant/Improved	Type Instrument	Qualification
12/1/1995	\$142,500	1102C	662	I - IMPROVED	WD - WARRANTY DEED	A - ACCEPTED
10/17/1988	\$102,500	643C	549	I - IMPROVED	WD - WARRANTY DEED	M - PHYSICAL DIFFERENCE
4/1/1986	\$0	550C	139		-	-
4/5/1937	\$0	31A	574		-	-