

Sullivan (082)
Tax Year 2026 | Reappraisal 2025

Jan 1 Owner
 DENTON BRADFORD H
 P O BOX 5084
 KINGSPORT TN 37663

Current Owner

PARK ST 1837
 Ctrl Map: 046M Group: L Parcel: 021.00 Pl: Sl: 000

Value Information

Land Market Value: \$12,200
Improvement Value: \$66,200
Total Market Appraisal: \$78,400
Assessment Percentage: 25%
Assessment: \$19,600

Subdivision Data

Subdivision: HIGHLAND PARK ADD
Plat Book: 1 **Plat Page:** 76A **Block:** 9 **Lot:** 10

Additional Information

General Information

Class: 00 - Residential
City #: 380
Special Service District 1: 000
District: 11
Number of Buildings: 1
Utilities - Water/Sewer: 01 - PUBLIC / PUBLIC
Utilities - Gas/Gas Type: 01 - PUBLIC - NATURAL GAS

City: KINGSPORT
Special Service District 2: 000
Neighborhood: K01
Number of Mobile Homes: 0
Utilities - Electricity: 01 - PUBLIC
Zoning:

Outbuildings & Yard Items

Building #	Type	Description	Area/Units
1	GUD - DETACHED GARAGE UNFINISHED	12X20	240

Sale Information

Long Sale Information list on subsequent pages

Land Information

Deed Acres: 0 **Calculated Acres:** .16 **Total Land Units:** 0.16

Land Code	Soil Class	Units
01 - RES		0.16

Residential Building #: 1

Improvement Type: 51 - SINGLE FAMILY
Exterior Wall: 04 - SIDING AVERAGE
Heat and AC: 0 - NONE
Quality: 0+ - BELOW AVERAGE +
Square Feet of Living Area: 824
Foundation: 02 - CONTINUOUS FOOTING
Roof Framing: 02 - GABLE/HIP
Cabinet/Millwork: 02 - BELOW AVG
Interior Finish: 07 - DRYWALL
Bath Tiles: 00 - NONE
Shape: 04 - IRR SHAPE

Stories: 1.00
Actual Year Built: 1920
Plumbing Fixtures: 3
Condition: AV - AVERAGE
Floor System: 04 - WOOD W/ SUB FLOOR
Roof Cover/Deck: 03 - COMPOSITION SHINGLE
Floor Finish: 08 - PINE/SOFT WOOD
Paint/Decor: 02 - BELOW AVERAGE
Electrical: 02 - BELOW AVG
Structural Frame: 00 - NONE

Building Sketch

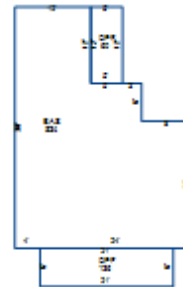

Building Areas

Areas	Square Feet
BAS - BASE	824
OPF - OPEN PORCH FINISHED	126
OPF - OPEN PORCH FINISHED	60

Sale Information

Sale Date	Price	Book	Page	Vacant/Improved	Type Instrument	Qualification
3/7/1997	\$32,500	1203C	88	I - IMPROVED	WD - WARRANTY DEED	A - ACCEPTED
10/27/1989	\$0	696C	677		-	-
4/18/1984	\$0	395C	232		-	-
9/16/1937	\$0	33A	230		-	-