

Sullivan (082)
Tax Year 2026 | Reappraisal 2025

Jan 1 Owner
 GRAYBEAL JOHN JAMESON
 738 MYRTLE ST
 KINGSPORT TN 37660

Current Owner

MYRTLE ST 738

Ctrl Map: 0460 Group: C Parcel: 010.00 Pl: Sl: 000

Value Information

Land Market Value: \$9,300
 Improvement Value: \$78,400
 Total Market Appraisal: \$87,700
 Assessment Percentage: 25%
 Assessment: \$21,925

Subdivision Data

Subdivision: CITY OF KINGSPORT
 Plat Book: A Plat Page: 15B Block: 76 Lot: 30

Additional Information

General Information

Class: 00 - Residential City: KINGSPORT
 City #: 380 Special Service District 2: 000
 Special Service District 1: 000 Neighborhood: K01
 District: 11 Number of Mobile Homes: 0
 Number of Buildings: 1 Utilities - Electricity: 01 - PUBLIC
 Utilities - Water/Sewer: 01 - PUBLIC / PUBLIC Zoning:
 Utilities - Gas/Gas Type: 01 - PUBLIC - NATURAL

Outbuildings & Yard Items

| Building # | Type | Description | Area/Units |
|------------|------|-------------|------------|
|------------|------|-------------|------------|

Sale Information

Long Sale Information list on subsequent pages

Land Information

Deed Acres: 0 Calculated Acres: .12 Total Land Units: 0.12

| Land Code | Soil Class | Units |
|-----------|------------|-------|
| 01 - RES | | 0.12 |

Residential Building #: 1

Improvement Type: 51 - SINGLE FAMILY
 Exterior Wall: 04 - SIDING AVERAGE
 Heat and AC: 5 - HEATING W/DUCTS
 Quality: 1 - AVERAGE
 Square Feet of Living Area: 792
 Foundation: 02 - CONTINUOUS FOOTING
 Roof Framing: 02 - GABLE/HIP
 Cabinet/Millwork: 03 - AVERAGE
 Interior Finish: 11 - PANELING BELOW AVG
 Bath Tiles: 00 - NONE
 Shape: 01 - RECTANGLE

Building Sketch

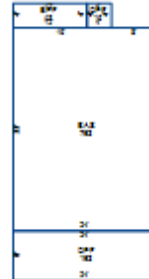

Stories: 1.00
 Actual Year Built: 1930
 Plumbing Fixtures: 3
 Condition: AV - AVERAGE
 Floor System: 04 - WOOD W/ SUB FLOOR
 Roof Cover/Deck: 00 - CORRUGATED METAL
 Floor Finish: 11 - CARPET COMBINATION
 Paint/Decor: 03 - AVERAGE
 Electrical: 03 - AVERAGE
 Structural Frame: 00 - NONE

Building Areas

| Areas | Square Feet |
|-------------------------------|-------------|
| BAS - BASE | 792 |
| EPF - ENCLOSED PORCH FINISHED | 48 |
| OPF - OPEN PORCH FINISHED | 16 |
| OPF - OPEN PORCH FINISHED | 192 |

Sale Information

| Sale Date | Price | Book | Page | Vacant/Improved | Type Instrument | Qualification |
|------------------|--------------|-------------|-------------|------------------------|------------------------|----------------------|
| 7/16/2021 | \$60,000 | 3455 | 2405 | I - IMPROVED | WD - WARRANTY DEED | A - ACCEPTED |
| 3/17/2021 | \$40,000 | 3434 | 1258 | I - IMPROVED | WD - WARRANTY DEED | J - ESTATE SALE |
| 6/30/1986 | \$0 | 3276 | 1784 | | WL - WILL BOOK | - |
| 10/5/1963 | \$0 | 0241A | 00080 | | - | - |