

Sullivan (082)
Tax Year 2026 | Reappraisal 2025

Jan 1 Owner
 O'ROURKE PATRICK J TRUSTEE
 P.O. BOX 237374
 COCOA FL 32923

Current Owner

E CENTER ST 1028

Ctrl Map: 046O Group: C Parcel: 021.00 Pl: Sl: 000

Value Information

Land Market Value: \$6,400
 Improvement Value: \$57,600
 Total Market Appraisal: \$64,000
 Assessment Percentage: 40%
 Assessment: \$25,600

Subdivision Data

Subdivision: CHARLES KING RESUB
 Plat Book: 123 Plat Page: 428 Block: Lot: 40F

Additional Information

PT LOT 40E

General Information

Class: 08 - Commercial City: KINGSPORT
 City #: 380 Special Service District 2: 000
 Special Service District 1: 000 Neighborhood: K15
 District: 11 Number of Mobile Homes: 0
 Number of Buildings: 1 Utilities - Electricity: 01 - PUBLIC
 Utilities - Water/Sewer: 01 - PUBLIC / PUBLIC Zoning:
 Utilities - Gas/Gas Type: 01 - PUBLIC - NATURAL

Outbuildings & Yard Items

Building #	Type	Description	Area/Units
------------	------	-------------	------------

Sale Information

Long Sale Information list on subsequent pages

Land Information

Deed Acres: 0 Calculated Acres: .02 Total Land Units: 25

Land Code	Soil Class	Units
10 - COM		25.00

Commercial Building #: 1

Improvement Type: 30 - OFFICE
 Quality: 1 - AVERAGE
 Foundation: 02 - CONTINUOUS FOOTING
 Roof Framing: 02 - GABLE/HIP
 Cabinet/Millwork: 02 - BELOW AVG
 Interior Finish: 11 - PANELING BELOW AVG
 Bath Tiles: 00 - NONE
 Shape: 01 - RECTANGLE
 Heat and AC: 03 - RADIANT HEAT
 Building Sketch

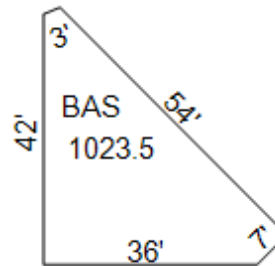

Actual Year Built:

1930

Business Living Area:

1023

Floor System:

04 - WOOD W/ SUB FLOOR

Roof Cover/Deck:

13 - PREFIN METAL CRIMPED

Floor Finish:

12 - CARPET

Paint/Decor:

03 - AVERAGE

Electrical:

03 - AVERAGE

Structural Frame:

00 - NONE

Plumbing Fixtures:

4

Interior/Exterior Areas

Type	Square Feet	Exterior Wall
30 - OFFICE	1,023	11 - COMMON BRICK

Commercial Features

Type	Units
------	-------

Sale Information

Sale Date	Price	Book	Page	Vacant/Improved	Type Instrument	Qualification
12/27/2024	\$60,000	3634	1015	I - IMPROVED	WD - WARRANTY DEED	A - ACCEPTED
1/30/2007	\$33,000	2499C	367	I - IMPROVED	WD - WARRANTY DEED	A - ACCEPTED
8/9/1979	\$0	216C	530		-	-
1/1/1979	\$19,000	216C	0530	I - IMPROVED	WD - WARRANTY DEED	A - ACCEPTED
3/1/1971	\$0	356A	19		-	-