

Sullivan (082)
Tax Year 2026 | Reappraisal 2025

Jan 1 Owner
 ARNOLD SUSAN C
 461 CANNON ST
 KINGSPORT TN 37664

Current Owner
CANNON ST 461
 Ctrl Map: 048H Group: C Parcel: 001.00 Pl: SI: 000

Value Information

Land Market Value: \$15,600
Improvement Value: \$89,600
Total Market Appraisal: \$105,200
Assessment Percentage: 25%
Assessment: \$26,300

Subdivision Data

Subdivision:
 E E HOOVEN SUB 3
Plat Book: **Plat Page:** **Block:** **Lot:**
 2 128B D 19

Additional Information

General Information

Class: 00 - Residential **City #:**
Special Service District 1: 000 **Special Service District 2:** K03
District: 10 **Neighborhood:** K03
Number of Buildings: 1 **Number of Mobile Homes:** 0
Utilities - Water/Sewer: 03 - PUBLIC / INDIVIDUAL **Utilities - Electricity:** 01 - PUBLIC
Utilities - Gas/Gas Type: 00 - NONE **Zoning:** R-3A

Outbuildings & Yard Items

Building #	Type	Description	Area/Units
1	STP - STOOP	8X16	128
1	CPY - CANOPY	8X16	128

Sale Information

Long Sale Information list on subsequent pages

Land Information

Deed Acres: 0 **Calculated Acres:** .21 **Total Land Units:** 0.21

Land Code	Soil Class	Units
01 - RES		0.21

Residential Building #: 1

Improvement Type:
 51 - SINGLE FAMILY
Exterior Wall:
 04 - SIDING AVERAGE
Heat and AC:
 7 - HEAT AND COOLING SPLIT
Quality:
 1 - AVERAGE
Square Feet of Living Area:
 1008
Foundation:
 02 - CONTINUOUS FOOTING
Roof Framing:
 02 - GABLE/HIP
Cabinet/Millwork:
 03 - AVERAGE
Interior Finish:
 11 - PANELING BELOW AVG
Bath Tiles:
 00 - NONE
Shape:
 01 - RECTANGLE

Building Sketch

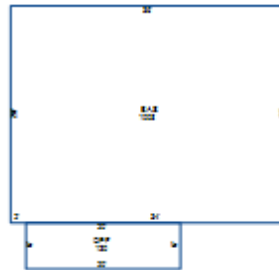

Stories:
 1.00
Actual Year Built:
 1948
Plumbing Fixtures:
 3
Condition:
 AV - AVERAGE
Floor System:
 04 - WOOD W/ SUB FLOOR
Roof Cover/Deck:
 03 - COMPOSITION SHINGLE
Floor Finish:
 09 - HARDWOOD/PARQUE
Paint/Decor:
 03 - AVERAGE
Electrical:
 03 - AVERAGE
Structural Frame:
 00 - NONE

Building Areas

Areas	Square Feet
BAS - BASE	1,008
OPF - OPEN PORCH FINISHED	120

Sale Information

Sale Date	Price	Book	Page	Vacant/Improved	Type Instrument	Qualification
3/14/2013	\$0	3071	1394		-	-
2/15/2012	\$0	3027	459		-	-
6/4/2009	\$0	2783C	623		-	-
3/31/2009	\$0	2757C	136		-	-