

**Sullivan (082)**  
**Tax Year 2026 | Reappraisal 2025**

Jan 1 Owner  
 HEAD ARCHIE DWAYNE &  
 REBECCA GAIL  
 417 CANNON ST  
 KINGSPORT TN 37664

Current Owner

**CANNON ST 417**

Ctrl Map: 048H    Group: C    Parcel: 009.00    Pl:    SI: 000

**Value Information**

**Land Market Value:** \$12,900  
**Improvement Value:** \$145,200  
**Total Market Appraisal:** \$158,100  
**Assessment Percentage:** 25%  
**Assessment:** \$39,525

**Subdivision Data**

**Subdivision:**  
 E E HOOVEN SUB 3  
**Plat Book:** 2    **Plat Page:** 128B    **Block:** D    **Lot:** 8

**Additional Information**

**General Information**

**Class:** 00 - Residential  
**City #:**  
**Special Service District 1:** 000  
**District:** 10  
**Number of Buildings:** 1  
**Utilities - Water/Sewer:** 03 - PUBLIC / INDIVIDUAL  
**Utilities - Gas/Gas Type:** 00 - NONE

**City:**  
**Special Service District 2:** 000  
**Neighborhood:** K03  
**Number of Mobile Homes:** 0  
**Utilities - Electricity:** 01 - PUBLIC  
**Zoning:** R-3A

**Outbuildings & Yard Items**

Building #	Type	Description	Area/Units
1	WDK - WOOD DECK	8X32	256

**Sale Information**

Long Sale Information list on subsequent pages

**Land Information**

**Deed Acres:** 0    **Calculated Acres:** .17    **Total Land Units:** 0.17

Land Code	Soil Class	Units
01 - RES		0.17

**Residential Building #: 1**

**Improvement Type:**  
 51 - SINGLE FAMILY  
**Exterior Wall:**  
 04 - SIDING AVERAGE  
**Heat and AC:**  
 8 - HEAT AND COOLING PKG  
**Quality:**  
 1 - AVERAGE  
**Square Feet of Living Area:**  
 828  
**Foundation:**  
 02 - CONTINUOUS FOOTING  
**Roof Framing:**  
 02 - GABLE/HIP  
**Cabinet/Millwork:**  
 03 - AVERAGE  
**Interior Finish:**  
 07 - DRYWALL  
**Bath Tiles:**  
 00 - NONE  
**Shape:**  
 01 - RECTANGLE

**Stories:**

1.00  
**Actual Year Built:**  
 2007  
**Plumbing Fixtures:**  
 3  
**Condition:**  
 AV - AVERAGE  
**Floor System:**  
 04 - WOOD W/ SUB FLOOR  
**Roof Cover/Deck:**  
 03 - COMPOSITION SHINGLE  
**Floor Finish:**  
 11 - CARPET COMBINATION  
**Paint/Decor:**  
 03 - AVERAGE  
**Electrical:**  
 03 - AVERAGE  
**Structural Frame:**  
 00 - NONE

**Building Sketch**

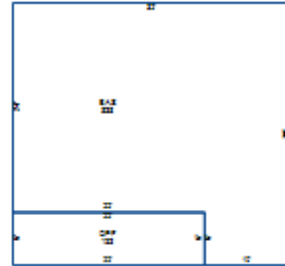

**Building Areas**

Areas	Square Feet
BAS - BASE	828
OPF - OPEN PORCH FINISHED	132

**Sale Information**

<b>Sale Date</b>	<b>Price</b>	<b>Book</b>	<b>Page</b>	<b>Vacant/Improved</b>	<b>Type Instrument</b>	<b>Qualification</b>
5/13/2021	\$90,000	3445	766	I - IMPROVED	WD - WARRANTY DEED	A - ACCEPTED
10/23/2015	\$74,900	3178	2161	I - IMPROVED	WD - WARRANTY DEED	A - ACCEPTED
12/18/2006	\$9,000	2515C	37	V - VACANT	WD - WARRANTY DEED	A - ACCEPTED
9/12/2002	\$21,000	1822C	323	I - IMPROVED	WD - WARRANTY DEED	I - FINANCIAL INSTITUTION
4/11/2002	\$10,800	1757C	724	I - IMPROVED	WD - WARRANTY DEED	G - FORCED SALE