

**Sullivan (082)**  
**Tax Year 2026 | Reappraisal 2025**

Jan 1 Owner  
 SHAFFER BRIAN ANTHONY  
 298 GREENTREE DR  
 BLOUNTVILLE TN 37617

Current Owner

**GREENTREE DR 298**  
 Ctrl Map: 049E    Group: A    Parcel: 008.00    Pl:    SI: 000

**Value Information**

**Land Market Value:** \$35,700  
**Improvement Value:** \$554,900  
**Total Market Appraisal:** \$590,600  
**Assessment Percentage:** 25%  
**Assessment:** \$147,650

**Subdivision Data**

**Subdivision:** GREENTREE  
**Plat Book:** 19    **Plat Page:** 18    **Block:**    **Lot:** TR19

**Additional Information**

**General Information**

**Class:** 00 - Residential    **City #:**    **City:**  
**Special Service District 1:** 000    **Special Service District 2:** 000  
**District:** 05    **Neighborhood:** V01  
**Number of Buildings:** 1    **Number of Mobile Homes:** 0  
**Utilities - Water/Sewer:** 03 - PUBLIC / INDIVIDUAL    **Utilities - Electricity:** 01 - PUBLIC  
**Utilities - Gas/Gas Type:** 00 - NONE    **Zoning:** A-2

**Outbuildings & Yard Items**

Building #	Type	Description	Area/Units
1	GUD - DETACHED GARAGE UNFINISHED	28X32	896
1	HAC - HEATING AND COOLING	28X32	896

**Sale Information**

Long Sale Information list on subsequent pages

**Land Information**

**Deed Acres:** 1.14    **Calculated Acres:** 1.16    **Total Land Units:** 1.16

Land Code	Soil Class	Units
01 - RES		1.16

**Residential Building #: 1**

**Improvement Type:** 01 - SINGLE FAMILY  
**Exterior Wall:** 11 - COMMON BRICK  
**Heat and AC:** 7 - HEAT AND COOLING SPLIT  
**Quality:** 2+ - ABOVE AVERAGE +  
**Square Feet of Living Area:** 2822  
**Foundation:** 02 - CONTINUOUS FOOTING  
**Roof Framing:** 02 - GABLE/HIP  
**Cabinet/Millwork:** 03 - AVERAGE  
**Interior Finish:** 07 - DRYWALL  
**Bath Tiles:** 00 - NONE  
**Shape:** 01 - RECTANGLE

**Building Sketch**

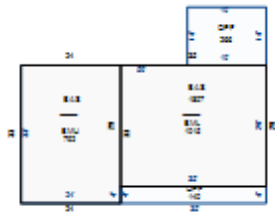

**Stories:**

1.00

**Actual Year Built:**

1990

**Plumbing Fixtures:**

6

**Condition:**

AV - AVERAGE

**Floor System:**

04 - WOOD W/ SUB FLOOR

**Roof Cover/Deck:**

03 - COMPOSITION SHINGLE

**Floor Finish:**

11 - CARPET COMBINATION

**Paint/Decor:**

03 - AVERAGE

**Electrical:**

03 - AVERAGE

**Structural Frame:**

00 - NONE

**Building Areas**

Areas	Square Feet
BAS - BASE	1,807
OPF - OPEN PORCH FINISHED	140
OPF - OPEN PORCH FINISHED	266
BML - BASEMENT LIVING AREA	1,015
BMU - BASEMENT UNFINISHED	792

**Sale Information**

<b>Sale Date</b>	<b>Price</b>	<b>Book</b>	<b>Page</b>	<b>Vacant/Improved</b>	<b>Type Instrument</b>	<b>Qualification</b>
4/24/2020	\$280,000	3379	2314	I - IMPROVED	WD - WARRANTY DEED	A - ACCEPTED
1/26/1987	\$0	536C	707		-	-
6/14/1984	\$8,500	402C	601	V - VACANT	WD - WARRANTY DEED	A - ACCEPTED
11/1/1983	\$0	375C	539		-	-