

Sullivan (082)
Tax Year 2026 | Reappraisal 2025

Jan 1 Owner
 DOTSON MARY F
 122 LINK RD
 BRISTOL TN 37620

Current Owner

LINK RD 122

Ctrl Map: 052 Group: Parcel: 005.00 Pl: SI: 000

Value Information

Land Market Value: \$16,400
Improvement Value: \$167,600
Total Market Appraisal: \$184,000
Assessment Percentage: 25%
Assessment: \$46,000

Additional Information

General Information

Class: 00 - Residential
City #:
Special Service District 1: 000
District: 05
Number of Buildings: 1
Utilities - Water/Sewer: 03 - PUBLIC / INDIVIDUAL
Utilities - Gas/Gas Type: 00 - NONE

City:
Special Service District 2: 000
Neighborhood: V01
Number of Mobile Homes: 0
Utilities - Electricity: 01 - PUBLIC
Zoning: R-3

Outbuildings & Yard Items

Building #	Type	Description	Area/Units
1	UTB - UTILITY BUILDING	IRR	405

Sale Information

Long Sale Information list on subsequent pages

Land Information

Deed Acres: 0	Calculated Acres: 0	Total Land Units: 0.64
Land Code	Soil Class	Units
04 - IMP SITE		0.64

Residential Building #: 1

Improvement Type:
 01 - SINGLE FAMILY
Exterior Wall:
 04 - SIDING AVERAGE
Heat and AC:
 7 - HEAT AND COOLING SPLIT
Quality:
 1 - AVERAGE
Square Feet of Living Area:
 1064
Foundation:
 02 - CONTINUOUS FOOTING
Roof Framing:
 02 - GABLE/HIP
Cabinet/Millwork:
 02 - BELOW AVG
Interior Finish:
 07 - DRYWALL
Bath Tiles:
 00 - NONE
Shape:
 01 - RECTANGLE

Stories:
 1.00
Actual Year Built:
 1954
Plumbing Fixtures:
 3
Condition:
 AV - AVERAGE
Floor System:
 04 - WOOD W/ SUB FLOOR
Roof Cover/Deck:
 13 - PREFIN METAL CRIMPED
Floor Finish:
 09 - HARDWOOD/PARQUE
Paint/Decor:
 03 - AVERAGE
Electrical:
 03 - AVERAGE
Structural Frame:
 00 - NONE

Building Sketch

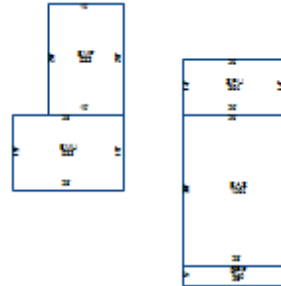

Building Areas

Areas	Square Feet
BAS - BASE	1,064
BMF - BASEMENT FINISHED	532
OPF - OPEN PORCH FINISHED	140
BMU - BASEMENT UNFINISHED	532
SPU - SCREEN PORCH UNFINISHED	364

Sale Information

Sale Date	Price	Book	Page	Vacant/Improved	Type Instrument	Qualification
1/17/2007	\$0	2494C	472		-	-
3/12/1984	\$0	388C	765		-	-
6/6/1980	\$0	274C	297		-	-
5/11/1977	\$0	274C	388		-	-