

Sullivan (082)
Tax Year 2026 | Reappraisal 2025

Jan 1 Owner
 WILSON LLOYD GRAY II &
 JENNY LYNN
 341 ROOTY BRANCH RD
 BRISTOL TN 37620

Current Owner

ROOTY BRANCH RD 341
 Ctrl Map: 055 Group: Parcel: 137.50 Pl: SI: 000

Value Information

Land Market Value: \$19,800
Improvement Value: \$306,800
Total Market Appraisal: \$326,600
Assessment Percentage: 25%
Assessment: \$81,650

Additional Information

General Information

Class: 00 - Residential
City #:
Special Service District 1: 000
District: 01
Number of Buildings: 1
Utilities - Water/Sewer: 11 - INDIVIDUAL / INDIVIDUAL
Utilities - Gas/Gas Type: 00 - NONE

City:
Special Service District 2: 000
Neighborhood: B03
Number of Mobile Homes: 0
Utilities - Electricity: 01 - PUBLIC
Zoning: A-1

Outbuildings & Yard Items

Building #	Type	Description	Area/Units
------------	------	-------------	------------

Sale Information

Sale Date	Price	Book	Page	Vacant/Improved	Type Instrument	Qualification
4/19/1984	\$0	226	122		-	-
1/1/1900	\$0	224	885		-	-

Land Information

Deed Acres: 1.17 **Calculated Acres:** 0 **Total Land Units:** 1.17

Land Code	Soil Class	Units
04 - IMP SITE		1.17

Residential Building #: 1

Improvement Type:
 01 - SINGLE FAMILY
Exterior Wall:
 05 - SIDING ABOVE AVG
Heat and AC:
 7 - HEAT AND COOLING SPLIT
Quality:
 1 - AVERAGE -
Square Feet of Living Area:
 1781
Foundation:
 02 - CONTINUOUS FOOTING
Roof Framing:
 02 - GABLE/HIP
Cabinet/Millwork:
 03 - AVERAGE
Interior Finish:
 04 - WOOD WALLS
Bath Tiles:
 00 - NONE
Shape:
 01 - RECTANGLE

Stories:
 2.00
Actual Year Built:
 1985
Plumbing Fixtures:
 9
Condition:
 AV - AVERAGE
Floor System:
 04 - WOOD W/ SUB FLOOR
Roof Cover/Deck:
 03 - COMPOSITION SHINGLE
Floor Finish:
 11 - CARPET COMBINATION
Paint/Decor:
 03 - AVERAGE
Electrical:
 03 - AVERAGE
Structural Frame:
 00 - NONE

Building Sketch

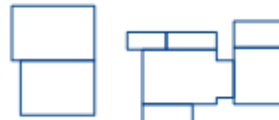

Building Areas

Areas	Square Feet
BAS - BASE	986
UTF - UTILITY FINISHED	300
EPF - ENCLOSED PORCH FINISHED	144
GRF - GARAGE FINISHED	650
OPU - OPEN PORCH UNFINISHED	184
OPU - OPEN PORCH UNFINISHED	184
USH - UPPER STORY HIGH	850
USL - UPPER STORY LOW	950