

Sullivan (082)
Tax Year 2026 | Reappraisal 2025

Jan 1 Owner
 RUSH WILLIAM ROBERT &
 LISA MARIE
 516 CAMPBELLS PVT DR
 BRISTOL TN 37620

Current Owner

CAMPBELLS PVT DR 512
 Ctrl Map: 055B Group: A Parcel: 010.00 Pl: SI: 000

Value Information

Land Market Value: \$12,300
Improvement Value: \$98,200
Total Market Appraisal: \$110,500
Assessment Percentage: 25%
Assessment: \$27,625

Additional Information

General Information

Class: 00 - Residential
City #:
Special Service District 1: 000
District: 01
Number of Buildings: 1
Utilities - Water/Sewer: 03 - PUBLIC / INDIVIDUAL
Utilities - Gas/Gas Type: 00 - NONE

City:
Special Service District 2: 000
Neighborhood: B03
Number of Mobile Homes: 0
Utilities - Electricity: 01 - PUBLIC
Zoning: A-1

Outbuildings & Yard Items

Building #	Type	Description	Area/Units
1	WDK - WOOD DECK	8X12	96

Sale Information

Long Sale Information list on subsequent pages

Land Information

Deed Acres: 0	Calculated Acres: 0	Total Land Units: 0.4
Land Code	Soil Class	Units
01 - RES		0.40

Residential Building #: 1

Improvement Type:
 51 - SINGLE FAMILY
Exterior Wall:
 04 - SIDING AVERAGE
Heat and AC:
 8 - HEAT AND COOLING PKG
Quality:
 1 - AVERAGE
Square Feet of Living Area:
 744
Foundation:
 02 - CONTINUOUS FOOTING
Roof Framing:
 02 - GABLE/HIP
Cabinet/Millwork:
 03 - AVERAGE
Interior Finish:
 07 - DRYWALL
Bath Tiles:
 00 - NONE
Shape:
 01 - RECTANGLE

Stories:
 1.00
Actual Year Built:
 1969
Plumbing Fixtures:
 3
Condition:
 AV - AVERAGE
Floor System:
 04 - WOOD W/ SUB FLOOR
Roof Cover/Deck:
 03 - COMPOSITION SHINGLE
Floor Finish:
 11 - CARPET COMBINATION
Paint/Decor:
 03 - AVERAGE
Electrical:
 03 - AVERAGE
Structural Frame:
 00 - NONE

Building Sketch

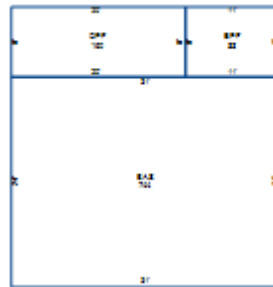

Building Areas

Areas	Square Feet
BAS - BASE	744
EPF - ENCLOSED PORCH FINISHED	88
OPF - OPEN PORCH FINISHED	160

Sale Information

Sale Date	Price	Book	Page	Vacant/Improved	Type Instrument	Qualification
11/8/2013	\$0	3100	2332		-	-
3/24/2010	\$0	765	76		-	-
1/6/2005	\$20,000	657	579	I - IMPROVED	WD - WARRANTY DEED	A - ACCEPTED
9/19/1985	\$0	241	81		-	-