

Sullivan (082)
Tax Year 2026 | Reappraisal 2025

Jan 1 Owner
 ROUSE JASON EMORY
 433 SHARPS CREEK RD
 BRISTOL TN 37620

Current Owner

SHARPS CREEK RD 433
 Ctrl Map: 057 Group: Parcel: 058.00 Pl: SI: 000

Value Information

Land Market Value: \$16,700
 Improvement Value: \$136,100
 Total Market Appraisal: \$152,800
 Assessment Percentage: 25%
 Assessment: \$38,200

Additional Information

General Information

Class: 00 - Residential
 City #:
 Special Service District 1: 000
 District: 19
 Number of Buildings: 1
 Utilities - Water/Sewer: 11 - INDIVIDUAL / INDIVIDUAL
 Utilities - Gas/Gas Type: 00 - NONE

City:
 Special Service District 2: 000
 Neighborhood: R01
 Number of Mobile Homes: 0
 Utilities - Electricity: 01 - PUBLIC
 Zoning: R-1

Outbuildings & Yard Items

Building #	Type	Description	Area/Units
1	UTB - UTILITY BUILDING	12X15	180
1	SHD - SHED	11X24	264

Sale Information

Sale Date	Price	Book	Page	Vacant/Improved	Type Instrument	Qualification
10/22/2004	\$0	610	549		-	-
5/30/1947	\$0	00101	00382		-	-

Land Information

Deed Acres: 0 Calculated Acres: 1.5 Total Land Units: 1.15

Land Code	Soil Class	Units
04 - IMP SITE		1.15

Residential Building #: 1

Improvement Type:
 01 - SINGLE FAMILY
Exterior Wall:
 04 - SIDING AVERAGE
Heat and AC:
 7 - HEAT AND COOLING SPLIT
Quality:
 1 - AVERAGE
Square Feet of Living Area:
 1152
Foundation:
 02 - CONTINUOUS FOOTING
Roof Framing:
 02 - GABLE/HIP
Cabinet/Millwork:
 02 - BELOW AVG
Interior Finish:
 07 - DRYWALL
Bath Tiles:
 00 - NONE
Shape:
 02 - L-SHAPED

Stories:
 1.00
Actual Year Built:
 1950
Plumbing Fixtures:
 3
Condition:
 AV - AVERAGE
Floor System:
 04 - WOOD W/ SUB FLOOR
Roof Cover/Deck:
 13 - PREFIN METAL CRIMPED
Floor Finish:
 07 - SHEET VINYL
Paint/Decor:
 03 - AVERAGE
Electrical:
 03 - AVERAGE
Structural Frame:
 00 - NONE

Building Sketch

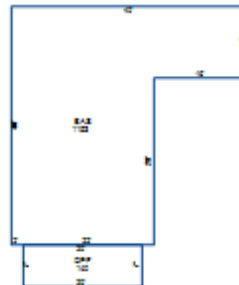

Building Areas

Areas	Square Feet
BAS - BASE	1,152
OPF - OPEN PORCH FINISHED	140