

**Sullivan (082)**  
**Tax Year 2026 | Reappraisal 2025**

Jan 1 Owner  
 WALKER SHELBA C  
 4167 HWY 421  
 BRISTOL TN 37620

Current Owner

**WALKERS PVT DR 118-132**  
 Ctrl Map: 058    Group:    Parcel: 003.00    Pl:    SI: 000

**Value Information**

Land Market Value: \$38,800  
 Improvement Value: \$71,400  
 Total Market Appraisal: \$110,200  
 Assessment Percentage: 25%  
 Assessment: \$27,550

**Additional Information**

**General Information**

Class: 00 - Residential  
 City #:    City:    Special Service District 2: 000  
 Special Service District 1: 000    Neighborhood: R01  
 District: 19    Number of Mobile Homes: 0  
 Number of Buildings: 1    Utilities - Electricity: 01 - PUBLIC  
 Utilities - Water/Sewer: 11 - INDIVIDUAL /    Zoning: R-1  
 INDIVIDUAL  
 Utilities - Gas/Gas Type: 00 - NONE

**Outbuildings & Yard Items**

| Building # | Type                   | Description | Area/Units |
|------------|------------------------|-------------|------------|
| 1          | WDK - WOOD DECK        | 8X14        | 112        |
| 1          | UTB - UTILITY BUILDING | 8X12        | 96         |

**Sale Information**

| Sale Date | Price | Book  | Page  | Vacant/Improved | Type Instrument | Qualification |
|-----------|-------|-------|-------|-----------------|-----------------|---------------|
| 5/29/1962 | \$0   | 00116 | 00566 |                 | -               | -             |

**Land Information**

Deed Acres: 4    Calculated Acres: 3.4    Total Land Units: 3.4

| Land Code     | Soil Class | Units |
|---------------|------------|-------|
| 04 - IMP SITE |            | 3.40  |

**Residential Building #: 1**

**Improvement Type:**  
 51 - SINGLE FAMILY  
**Exterior Wall:**  
 04 - SIDING AVERAGE  
**Heat and AC:**  
 0 - NONE  
**Quality:**  
 0 - BELOW AVERAGE  
**Square Feet of Living Area:**  
 966  
**Foundation:**  
 01 - PIERS  
**Roof Framing:**  
 02 - GABLE/HIP  
**Cabinet/Millwork:**  
 02 - BELOW AVG  
**Interior Finish:**  
 07 - DRYWALL  
**Bath Tiles:**  
 00 - NONE  
**Shape:**  
 00 - SQUARE

**Stories:**  
 1.00  
**Actual Year Built:**  
 1900  
**Plumbing Fixtures:**  
 3  
**Condition:**  
 AV - AVERAGE  
**Floor System:**  
 03 - WOOD W/O SUB FLOOR  
**Roof Cover/Deck:**  
 00 - CORRUGATED METAL  
**Floor Finish:**  
 08 - PINE/SOFT WOOD  
**Paint/Decor:**  
 02 - BELOW AVERAGE  
**Electrical:**  
 02 - BELOW AVG  
**Structural Frame:**  
 00 - NONE

**Building Sketch**

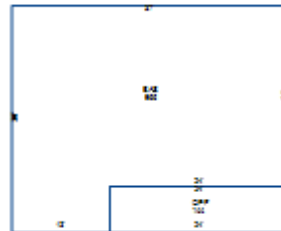

**Building Areas**

| Areas                     | Square Feet |
|---------------------------|-------------|
| BAS - BASE                | 966         |
| OPF - OPEN PORCH FINISHED | 144         |